

GENERAL INFORMATION COVER SHEET

Inspection Code EOI Event No. 8072776
 Company Name Performance Coal Company
 Mine Name Upper Big Branch Mine - South
 Mine I.D. Number 46-08436

Date(s) of Mine File Review 10- - 09
 D Status Yes Citation/Order No. 8082602 Date 3-17-09

Dates of Inspection: 10-7-09 completed

Pre-Inspection Conference Date 10-7-09

Company Representative(s) Gary May,
Black Superintendent

Miners Representative(s) None

Post-Inspection Conference Date 12-30-09

Company Representative(s) Gary May
Superintendent

Miners Representative(s) None

Comments:

Inspector's Initials [redacted] Supervisor's Initials and Date [redacted] 10-5-9

DAILY COVER SHEET

Date 10-6-09 Event No. 8072776

Arrived at the Mine 0830 Departed from the Mine

List Records Books Checked Beat Books

Accompanied By: Company Representative Virgil
Bowman Maint. Foreman

Miners Representative None

AREAS OF INSPECTION ACTIVITY:

- 1) Records.
- 2) C/O North Side.

Inspector's Initials [redacted] 10-15-9

Supervisor's Initials and Date [redacted] 10/9/09 Page No. 1

Date 10-06-09
Arrived at H.Q.

Prepared For Inspection

Traveled to Mine

Site. Meet with

Gary May, talked

to him about recording

Beat Air violation Reading

in the beat Book,

provided him

Inspector's Initials [redacted] 10-15-9

Supervisor's Initials and Date [redacted] Page No. 2

Date 10-6-09
 with instruction
 on how Air velocity
 Reading procedure.
 Meet with Virgil
 Bowman - Maint.
 Foreman. Talked
 to him about
 placement of C/O
 Sensors - as per

Inspector's Initials

Supervisor's Initials and Date

Page No. 3

Date 10-06-09
75-3516 that
 Kick in 12-31-09
 Gave Virgil a
 copy of the QTA
 For that Fed Register
 Traveled up to
 The Ellis Punch
 To check C/O
 on these Belts.

Inspector's Initials

Supervisor's Initials and Date

Page No. 4

Date 10-06-09
 Traveled in #11
 Mantrip.
 Ellis #4 Belt is
 the one ~~that~~ that
 exits the mine at
 Ellis portal.
 Check C/O sensor
 #127 at Ellis portal
 N/O. Took Air.

Inspector's Initials

Supervisor's Initials and Date

Page No. 5

Date 10-6-09

Reading in by That

Sensor Approximately

50'. Had 122 LFM,

check CO at

ELLIS #5 Head

Took Air Reading

100' in by drive

Smoke traveled

25' For 30 sec

Inspector's Initials

Supervisor's Initials and Date

Page No.

Date 10-6-09

and again For 22

Sec For an average

of 26 seconds;

$$V = \frac{60}{26} \times 25 = 57.69$$

LFM.

Check sensor at

#10 ELLIS 5 Boat

when Virgil tested

Sensor at ELLIS

Inspector's Initials

Supervisor's Initials and Date

Page No.

Date 10-6-09

#4 fail He forgot

to tell the AMS

operator. The AMS

operator in turn

dispatched a Fire

Boss to check the

Sensor. That was

a good response,

Took Air Reading

Inspector's Initials

Supervisor's Initials and Date

Page No.

Date

10-6-09

at #10 Break on #5

Ellis Belt Had Read

of 170 LFM.

Checked Sensor at

#20 Break #5 Ellis

Belt, Air 135 LFM.

Checked Sensor

4 North Belt discharge

Air Reading 60 LFM.

Inspector's Initials

Supervisor's Initials and Date

Page No.

10-15-9

9

Date

10-6-09

Checked Sensor

of Air Reading at

22 Break on #4 North

Belt, Air 135 LFM.

Checked C/O sensor

5 North Belt

Drive + Air in by

Drive 1001; Air =

155 LFM.

Inspector's Initials

Supervisor's Initials

Page No.

10-6-9

10

Date

10-6-09

Checked C/O sensor

+ Air at 54 BRK

5 North Belt Air is

145 LFM

Checked Sensor

Air at 6 North

Head, Air = 85 LFM

Checked Sensor

and air at BRK

Inspector's Initials

Supervisor's Initials and Date

Page No.

10-6-9

11

Date 10-6-09#89 on 6 North
Bent Pipe: 55 LFMTraveled Back to
the surface.Talked with the AMS
operator about his
Response to the sensor
tested by Virgil & told
him that he done
well. Also relayed

Inspector's Initials

Supervisor's Initials and Date

Page No.

Date 10-16-09

to Evert Kagar

Foreman, a positive
note that the AMS
operator Responded
well. Talked with

[REDACTED] about

L.W. Hose Safety &
gave him a copy
of a Safety

Inspector's Initials

Supervisor's Initials and Date

Page No.

Date 10-6-06

Bulletin issued

By Byrckins about
Hose Safety,
Returned for H.O.

Inspector's Initials

Supervisor's Initials and Date

Page No.

DAILY COVER SHEET

Date 10-6-09 Event No. 9072776

Arrived at the Mine 0740 Departed from the Mine _____

List Records Books Checked Preshift/OSHA sections & Belts

Accompanied By: Company Representative Gary Mat

Miners Representative _____

AREAS OF INSPECTION ACTIVITY:

#3 Section 064 mm
Belted Parameters
Working Faces
No Production

Inspector's Initials [Redacted]
Supervisor's Initials and Date [Redacted] 10-8-9 Page No. 1

Date 10-6-09
Arrived at Off. Reviewed
my EMail and Mail.

Traveled to the mine.

Met Gary Mat, Super, and
told him I was doing a
health inspection on the
064 mm #3 section
left side.

Reviewed the Preshift/OS
Shift Report for the
#3 section and Belts.

Reviewed the Mine map
for old works and
hazardous conditions.

Inspector's Initials [Redacted]
Supervisor's Initials and Date [Redacted] 10-8-9 Page No. 2

Date 10-6-09
Informed management
I needed the 30 shift
production average.

I got a section map
to keep cuts and making
locations.

Traveled to the section
by Rail with Gary Mat

Met the section Foreman,
Perdue and told
him what I was doing

Checked the faces #7
to #1 for Immediate
Dangers.

Inspector's Initials [Redacted]
Supervisor's Initials and Date [Redacted] 10-8-9 Page No. 3

Date

10-6-09

#7 Face 184 steps 0% CH₄
 20.8% O₂ Roof & Vent Good
 #6 Face Flush 0% CH₄
 20.8% O₂ Roof & Vent Good
 #5 Face Flush 0% CH₄
 20.8% O₂ Roof & Vent Good
 #4 Face 135.3 feet 0% CH₄
 20.8% O₂ Roof & Vent Good
 #3 Face Flush 0% CH₄
 20.8% O₂ Roof & Vent Good
 #3 to 2 Face Scraped 0% CH₄
 20.8% O₂ Roof & Vent Good
 #2 Face 60 feet 0% CH₄
 20.8% O₂ Roof & Vent Good
 #1 Face 30 feet 0% CH₄
 20.8% O₂ Roof & Vent Good
 DITs provided, clean &
 DUSTING Good.

Inspector's Initials

Supervisor's Initials and Date

Page No.

4

Date

10-6-09

The 064 mm / 16 1/8 left
 side #1 to #3 & #4 Airt
 Time.
 The Height is 48 inches.
 The roadway and the
 are dry.
 The section is dark
 making a belt move
 at this time.

Checked the Fletcher
 Bolter ser #2003318
 Roof Raiser II
 Pre Dump - Yes
 No collection Bags
 Dust Box Gasgets OK
 Filters OK
 Vacuum LK 14 RT 13

Inspector's Initials

Supervisor's Initials and Date

Page No.

5

Date

10-6-09

Talked with the Airt
 crew and electrician
 about the importance
 of maintaining the Airt
 system on the matter.

Returned to the surface
 by Rail with Earl May.

Gota copy of the last
 30 Days production.

The miner does not run
 a scrubber. The section
 is on a 20 ft live curtain.

Inspector's Initials

Supervisor's Initials and Date

Page No.

6

Date

10-6-09

Returned to HQ.

Entered the T&A form.

Entered People Time

Inspector's Initials

Supervisor's Initials and Date

Page No.

GPO U.S. GOVERNMENT PRINTING OFFICE: 2009-540-493

DAILY COVER SHEET

Date

10-7-09

Event No.

8072776

Arrived at the Mine

5:30

Departed from the Mine

List Records Books Checked

Fresh. ET + Onsh. ET

Long wall

Accompanied By: Company Representative

Jack Roles, Longwall Supervisor

Miners Representative

None

AREAS OF INSPECTION ACTIVITY:

#12 Jeep, Longwall face,
Battle Action tailgate, Walked
the tailgate to the #12
Section, Pump, Starter Box

Inspector's Initials

Supervisor's Initials and Date

Page No.

Government Printing Office: 1997 - 508-470

Date

10-7-09

Arrived at the MSHA
office got down, got my
shift, SICK and bump
test my detector. Drove
to the UED mine
office. Had a pre-conference
inspection with Gary May.
Checked the Fresh +
Onsh. for the Longwall.
None observed on the
Fresh + Onsh. ~~Had~~
Had to wait for a
ride. Checked #12
Jeep NVO.
The operator has installed
additional roof support
along the track for
the North Road

Inspector's Initials

Supervisor's Initials and Date

Page No.

GPO U.S. GOVERNMENT PRINTING OFFICE: 2009-540-493

Date

10-7-09

to the Ellis switch
 9:00am, Traveled
 from the Mack Picket
 to the end of the
 track for the longwall
 Took in reading on the
 longwall. NVO Traveled
 from the headgate to
 the tailgate NVO.
 Took in reading along
 the tail NVO
 walking the tailgate
 only 20 SCSR
 at 24+00.
 Flygt Pump #2125051
 at 34+00 NVO
 Starter box Flygt
 Serial # M09-0250 NVO

Inspector's Initials

Supervisor's Initials and Date

10-8-09

Page No.

3

Date

10-7-09

Walked off the tailgate
 to #2 Section, NVO
 Traveled the track
 from #2 Section Belt
 head to the North Post
 NVO.

Inspector's Initials

Supervisor's Initials and Date

10-8-09

Page No.

4

AIR READINGS

Date

10-7-09

Location

Intake for
 longwall

Width

19

Bottle Sample No.

Height

7.5

CH4 Detected

0.00%

Area

143

Mean Entry

Velocity

470

Time

10:00

Quantity

61,490

0.220.8%

Location

Jack #9

Width

Bottle Sample No.

Height

CH4 Detected

0.00%

Area

Mean Entry

Velocity

620-10(610)

Time

10:15

Quantity

0.220.8%

Inspector's Initials

Supervisor's Initials and Date

10-8-09

Page No.

5

AIR READINGS

Date 10-7-09
 Location Jack 110
 Width _____ Bottle Sample No. _____
 Height _____ CH4 Detected 0.05%
 Area _____ Mean Entry _____
 Velocity 255+15(270) Time 10:40
 Quantity 0039.8%
 Location Tailgate

Width 19.5 Bottle Sample No. 8514
 Height 7 CH4 Detected 0.05%
 Area 127 Mean Entry _____
 Velocity 100+13(135) Time 10:50
 Quantity 10495 0021.0%

Inspector's Initials [Redacted]
 Supervisor's Initials and Date [Redacted] 10/8/09 Page No. 6

DAILY COVER SHEET

Date 10-7-09 Event No. 8072776
 Arrived at the Mine 0545 Departed from the Mine _____
 List Records Books Checked Preshist 10/8/09
Section 4 Belt
 Accompanied By: Company Representative Rick Foster
 Miners Representative _____

AREAS OF INSPECTION ACTIVITY:

Respirable Dust 064 mmC

Inspector's Initials [Redacted]
 Supervisor's Initials and Date [Redacted] 10/8/09 Page No. 1

Date 10-7-09
Arrived at HQ, Gathered
Pumps and tested, All
are 5+ Volts @ 2 LPM.

Reviewed my mail and E
Mail.

Traveled to the mine and
met Gary Mack, Super.
and told them I was
running dust.

Reviewed the Preshist
on shift for the section
and Belts.

Inspector's Initials [Redacted]
 Supervisor's Initials and Date [Redacted] Page No. 2

Date 10-7-09

Started the Pumps and
put them on the way.
At 2:00 PM

Traveled to the section by
rail with Tim Foster behind
the crew due to the meeting
being full.

Checked the faces #7 to #1
for Immigrant Dangers
#7 face 20 feet in 0% CH₄
20.8% O₂
#6 face 20 feet in 0% CH₄
20.8% O₂
#5 face 20 feet in 0% CH₄
20.8% O₂

Inspector's Initials

Supervisor's Initials and Date

10-89Page No. 3Date 10-7-09

#4 face flush 0% CH₄
20.8% O₂
#3 face flush 0% CH₄
20.8% O₂
#2 face flush 0% CH₄
20.8% O₂
#1 face 40 feet in 0% CH₄
20.8% O₂

cleaning and doing Good
Roof Control & Ventilation
is Good PT Is Provided

Checked Parameters on
the Bolton Fletcher
RR II 13A 2008322
ser. #. The operator side
has 13 inches of mercury
and 14 inches on the ~~85~~
side

Inspector's Initials

Supervisor's Initials and Date

10-99Page No. 4Date 10-7-09

checked the parameters
on the mixer Jot-14-10
has 30 sprays @ 80 PSI

Made the 1st check on the
pumps. At 2:00 PM ok

The section did not start
producing until 1:00 hr
due to belt problems.

Took an LOR Reading

checked the dust boxes
on the Bolton Gargals
Good Filters Good
it does have a problem.

Inspector's Initials

Supervisor's Initials and Date

10-89Page No. 5

Date 10-7-09Made the 2nd check on
The Pumps. At 2 LPM okMade the mid shift
check on the boiler
it is 13 inches of mercury
on the operator side
and 14 on the off sideThe roadways and
faces are damp.The mined height is
48 inches.No respirators are worn
on this crew.Inspector's Initials [redacted]Supervisor's Initials and Date [redacted] 10-9-09Page No. 4Date 10-7-09Made a mid shift check
of the Mikes 30 spray
@ 80 PSI

Sprays are as plan.

Made a mid shift LEB
check.The section produced
41 feet which is 100%
of the past 30 shifts.
125 tonsAccompanied the Foreman
as he made the pre shift
exam of the section he
did a good job.Inspector's Initials [redacted]Supervisor's Initials and Date [redacted] 10-9-09Page No. 7Date 10-7-09Gathered up the pumps
and returned to the
surface by Rail with
Rick Foster.Shut the pumps off. All
2 LPM.Held a close out conference
with Gary Mat and Rick
Foster

Returned to HQ.

Disassembled, cleaned and
put the pumps on chargeInspector's Initials [redacted]Supervisor's Initials and Date [redacted] 10-9-09Page No. 8

Date 10-7-09

Filled out the Dist Dist
Cards and got them ready
to mail.

Filled out the enviro notes
Dist Inspection Card.

Entered the Tota Scan

Entered People Time

Inspector's Initials 

Supervisor's Initials and Date

Page No. 9

AIR READINGS

Date 10-7-09Location 2nd LCB

Width 20 Bottle Sample No. —
 Height 4 CH4 Detected 0
 Area 80 Mean Entry —
 Velocity 135 Time 0820
 Quantity 10800
 Location LOB

Mid Shift
 Width 20 Bottle Sample No. —
 Height 4 CH4 Detected 0
 Area 80 Mean Entry —
 Velocity 190 Time 1240
 Quantity 15200

Inspector's Initials 

Supervisor's Initials and Date

Page No. 10

AIR READINGS

Date 10-7-09Location #3 Face

Width 10 Bottle Sample No. —
 Height 4 CH4 Detected 0.9%
 Area 40 Mean Entry Open Face
 Velocity 200 Time 1040
 Quantity 4000 20.802
 Location #4 Face

2nd LCB
 Width 9 Bottle Sample No. —
 Height 4 CH4 Detected 0.9%
 Area 36 Mean Entry Open Face
 Velocity 185 Time 1150
 Quantity 5220 20.802

Inspector's Initials 

Supervisor's Initials and Date

Page No. 11

Inspector's Initials

Supervisor's Initials and Date

Page No.

12

PUMP	CASSETTE	CODE	OCCUPATION	TIME ON	2nd	4th	TIME OFF	WT
233	828732	046	Bolter	0630	0800	1030	1430	
232	828743	036	Miner					
231	828712	046	Bolter					
231	828746		Intalle					
229	828744	050	SLC					
228	828745	050	SLC					
	828716		Castner					

MSHA Form 7000-10I, June 93 (revised)

DAILY COVER SHEET

Date 10-8-09 Event No. 8072776Arrived at the Mine 0830 Departed from the Mine _____List Records Books Checked 4 Section Weekly
exmn. Pres Lift 4 Sec.Accompanied By: Company Representative Paul Thompson
& David TaraczkoMiners Representative None.

AREAS OF INSPECTION ACTIVITY:

- (1) Records
- (2) Safety Talk
- (3) Imm Dgr Run.
- (4) Checked City spotter
- (5) Equipment Inspectors

Inspector's Initials _____

Supervisor's Initials and Date 10/9/09 Page No. 2

MSHA Form 7000-10K, June 93 (revised)

Date 10-8-09
Arrived HQ preparedfor inspection. Traveledto mine. Meet withpaul Thompson &Had Safety talkwith 4 owl shiftElectrician aboutfixing off when

Inspector's Initials _____

Supervisor's Initials and Date 10-159 Page No. 2

Date 10-8-09
Working at elevated

Locations - Discussed

Fatal #12.

Check #4 Section.

Weekly Elect EXAM

Back

#2 Scoop - Fire

Sapp Button Missing

ordered 10.12.09
installed OK

Inspector's Initials AM

Supervisor's Initials and Date _____ Page No. 2

Date 10-8-09
The MINU # Fore

4 section is 0628

063, 4 Section Prestige
12340648 NO

3 BK RT need CTD

5 & 7 - Rmk Lmr.

LT LWB 22800

RT LWB 23410,

Travelled U/G

To 4 section

James Woods is

Section Foreman

Inspector's Initials AM

Supervisor's Initials and Date AM 10.15.09 Page No. 3

Date 10-8-09
Done IDR

From #9 - across to

Layd = #9 stopper

#8 Miner Leading NW.

#5 NEDD.

#6 NEDD

#5 NEDD #4, NEDD.

Checked Solaris

Serial # A5-80600 Lax

call 9-29-09

Inspector's Initials AM

Supervisor's Initials and Date AM 10.15.09 Page No. 4

Date

10-8-09

A3 NID C

A2 NID C

A1 NID C

090 ch4 detected

DTI in place.

2008301 = Roof
 Ranger #2, Chuck
 Permiss. Did not
 cut cable yet.
 Rest of machine -
 well maintained

Jay 1032-SC-AT17
 648 = well main
 NVO

Inspector's Initials

HJ

Supervisor's Initials and Date

10-10-57

Page No.

Date

10-9-08

AET 2500KVH

Sep 27-262-2500

1008 - Section PC

NVO

Had Safety Talk

with Electrician

about Trouble

Shooting Cables,

Fairchild 35C

T339-181 Scoop

NVO

Inspector's Initials

HJ

Supervisor's Initials and Date

10-10-57

Page No.

Date

10-9-09

#2 Scoop charger,

Ground Hog.

EL 1353 Ser #

NVO,

Traveled Back

to Surface.

Closed with Paul

David For the

day. Told Paul

and David that

From what el

Inspector's Initials

HJ

Supervisor's Initials and Date

10-10-57

Page No.

Date 10-9-09

inspected to
 this point it
 appears that they
 have a working
 maintenance program
 and are doing
 well. There was
 some question on
 record keeping

Inspector's Initials APDSupervisor's Initials and Date 10-10-09Page No. 8Date 10-9-09

That have been
 Resolved
 Returned to
 H.A. Lane
 paper work,

Inspector's Initials WVSupervisor's Initials and Date 10-10-09Page No. 9

DAILY COVER SHEET

Date 10-8-09Event No. 8072776

Arrived at the Mine _____

Departed from the Mine _____

List Records Books Checked _____

Accompanied By: Company Representative _____

Miners Representative _____

AREAS OF INSPECTION ACTIVITY:

Completed form 2000-86
 and report on the
 Respirable Dust Samples

Inspector's Initials MS

Supervisor's Initials and Date _____

Page No. 1

DAILY COVER SHEET

Date 10-14-9 Event No. 6288652Arrived at the Mine 0800 Departed from the Mine List Records Books Checked gro-shift/onshiftAccompanied By: Company Representative Evans Hager, Gary MayMiners Representative None

AREAS OF INSPECTION ACTIVITY:

- mmu 029
- Travel from surface to
- 029
- #1 belt (section 15)
- Longwall belt from #1 head
- to Re 2 head.

Inspector's Initials 10-15-9Supervisor's Initials and Date Page No. 1Date 10-14-9mat with(wash inspection) and EVANS
Hager and Gary May.Travel from the
surface to mmu 029
section. The mine
roof along the track
appears solid, octThe section is on
Oliver, oct, Hager
with Kevin 2 yall us
We checked the focus,
N.V.D. on Ventilation
controls are in placeTravel the #1 section
belt, and the longwall
belt from # head to
the stone. octInspector's Initials 10-15-9Supervisor's Initials and Date Page No. 2Date The mine roof appears
solid, the belt entry
is well rock dusted
and is wet and
dry in several areas,
near the Re 2 box and
the two ~~split~~ split
box.Travel from the
EW belt head to the
surface.Inspector's Initials 10-15-9Supervisor's Initials and Date Page No. 3

Product - as

DAILY COVER SHEET

Date 10-14-09

Event No. 6388652

Arrived at the Mine 7:30

Departed from the Mine

List Records Books Checked Proshiff + Onshiff

#1 Section, Proshiff Exam of Belt

Accompanied By: Company Representative

Covito Hager, Superintendent

Miners Representative None

AREAS OF INSPECTION ACTIVITY:

#12 Jeep, Intake Phase #1
 Section, #1 Section, #1 Belt,
 Truck to #1 Section, OTI, Face,
 #1 Section, Immediate Return
 Bottle, #1 Belt #5 Section KVA,
 #6 North KVA, #6 North Beltline
 Line Splitter @ 75 S North belt,
 #5 North beltline.

Inspector's Initials

Supervisor's Initials and Date

10-15-09

Page No. 1

Date

10-14-09

Arrived at the MSHA
 got truck, checked
 CH4 spatter got
 my light and SC5th.
 Went to my office
 got my computer
 and checked email.
 Traveled to cell
 with [REDACTED]
 Got dress and went
 up stairs to check
 the Proshiff + Onshiff
 book for #1 Section,
 LOB 20,600 in the
 Proshiff book, Proshiff
 Exam of Belt, checked
 the #12 Jeep NVO
 Traveled to the #1 Section

Inspector's Initials

Supervisor's Initials and Date

10-15-09

Page No. 3

Date

10-14-09

on the track NVO
 while on the truck.
 Aired to the end
 of the track, Wal had
 to the bottom. Checked
 the intake phase
 NVO. Went across the
 face #1-4 NVO, 9th
 section is well rock
 dusted. NVO on
 the section. Took
 L-PB 2-1 entry NVO.
 good air on the
 section. Took immediate
 return in reading,
 it is good. NVO.
 The top in #3 entry
 has spell stuck

Inspector's Initials

Supervisor's Initials and Date

10-15-09

Page No. 3

Date 10-14-09rock about 2 to 3feet underneath top.Date, time and intakeare in all facearea. Walked the#1 Section BeltNVO.Checked into KVA forthe #1 Section Belt#1 Section Belt KVASerial # 29984-520-401NVO#6 North Head KVASerial # 22038-2300-1205NVOTraveled to #6North beltlineNVO while travelingInspector's Initials [redacted]Supervisor's Initials and Date [redacted]Page No. 4Date 10-14-09the #6 North beltline, Line Splitter @TS break on #5 NorthBelt. Serial # 22938-206NVOTraveled to #5 Northbeltline NVO.Traveled to the surfaceon the track, NVOwhile on the track,Had a conversation withEverett Hager spoketo him about agood job on the #6 +#5 North beltline.Traveled back toMSHA office.Inspector's Initials [redacted]Supervisor's Initials and Date [redacted]Page No. 5

AIR READINGS

Date 10-14-09Location LOB #1 Section2x1Width 20Bottle Sample No. [redacted]Height 7CH4 Detected 0.00%Area 140Mean Entry [redacted]Velocity 148.15(213)Time 10:45Quantity 29,8200.20.8%Location Immediate Return#1 EntryWidth 20Bottle Sample No. 02704Height 8CH4 Detected 0.05%Area 160Mean Entry [redacted]Velocity 215Time 10:52Quantity 34,4000.20.8%Inspector's Initials [redacted]Supervisor's Initials and Date [redacted]Page No. 6

Date

10/14/09

KVA 24989-500-409 NVO
Section 0029 Power Station

D-Box 27548-208 NVO
Old North Maine @ 79 break

Flgts 043000/ 46 Break
Pump on Belt Line #5

KVA 22039-2300-106
Maine #5 Head

Inspector's Initials

Supervisor's Initials and Date

10-15-09

Page No.

7

DAILY COVER SHEET

Date 10-15-09

Event No. 6288652

Arrived at the Mine 8:00

Departed from the Mine

List Records Books Checked Proshift + Onshift
#2 Section

Accompanied By: Company Representative Everett

Hargrove, Superintendent

Miners Representative None

AREAS OF INSPECTION ACTIVITY:

Proshift + Onshift Book for #7 Section
#4 North Beltline, #5 Ellis,
#4 Ellis beltline, #2 D-box
4 North Head, 40 break pump,
36 break pump, 17 break pump, 12 break
pump, 44 Head KVA, #4 N line spl. rky
#1 D-box @ 4 Head, #2 charger Ellis
Switch, Ellis Ranchard D-box, #1 Charger,
Ellis Ranchard, #5 Ellis KVA, Ellis Ranch
out D-box

Inspector's Initials

Supervisor's Initials and Date

10-15-09

Page No.

1

Date

10-15-09

Arrived at the MHA Hope
MHA office. I got dress
in D pump test my CH4
spotter, got my light
and SCR, I came
to office sign my
self out. Checked
my email. Arrived
at the UBB Office
checked the Proshift
+ Onshift for #2 Section.
#1 #3 #5 #6 #7 None observed,
#2 need clean + unshot, #6 R
needs cleaned.

LOB 21,860

#7 Section #1 and #2

Belts need additional dusting

Inspector's Initials

Supervisor's Initials and Date

10-15-09

Page No.

2

Date

10-15-89

Aide the truck
to the #5 North
Beltline NVO
inside on the
track. Traveled to
#4 North Beltline NVO.

keeping notes for
the equipment that
we checked.

Checked the #2 Box NVO
Serial # N/A

at #11 North Head
Traveled the #4 North
Beltline found at
36+37 that bottom
belt hanger with
the belt rubbing

Inspector's Initials

Supervisor's Initials and Date

10-19-9

Page No.

3

Date

10-15-89

the bottom belt
hanger. They were
not to the truck
and a little rock
coming off of the
hanger.

Traveled to #5
Ellis Beltline
found #1 back only
the #5 Head bottom
hanger along the
bottom roller was
worn flat. The
bottom half roller
was not even
worn. Traveled
the #4 Ellis Beltline
NVO. Traveled to

Inspector's Initials

Supervisor's Initials and Date

10-19-9

Page No.

4

Date

10-15-89

the Ellis punchout
across the sidewalk
to the side door
into the tunnel. Traveled
the truck back to
the North Portal
from the Ellis
punchout. NVO
were while tracking
the truck.
Spoke to the operator
about root cause of
the incident on the
Belt. I clearly
communicated to the
operator on any
findings.

Inspector's Initials

Supervisor's Initials and Date

10-19-9

Page No.

5

Date

10/15/09

Arrived @ Mine Office 8:00
 Checked pump book #1 & #2
 section. Looked over
 Hazards. Checked
 Belt book.

Road to Ellis entry
 with [REDACTED]
 Everett Hanger

Break #40 pump on #
 4 North Belt #81162
 NVO

Truck cluster in #40 Buck
 NVO

Traveled #36 Bel Pump down D-Ba
 NVO

Inspector's Initials

Supervisor's Initials and Date

10/15/09

Page No.

1A

Date

10/14/09

Flyte pump #17 Break 4N.
 Belt N/A NVO

Flyte pump #12 Break 4
 N-Belt N/A NVO

#4 N ^{Head} ~~Head~~ KVA 22037-23001105
 NVO

#4 N Line splitter 28964-1108
 NVO

#1 D-Box 4-N Head. NVO
 11175-997

#2 charger GH39454
 #4 Ellis switch O/S

Inspector's Initials

Supervisor's Initials and Date

10/14/09

Page No.

2A

Date

10/15/09

Ellis Punch out D-Box O/S
 NVO

#1 Charger GH40651 O/S
 NVO

KVA-Ellis #5 Head NVO
 8798-1000-296

Ellis Punch out office
 18937-100-303 NVO

Walked #4 N-Belt
 Walked #4 Ellis belt
 Walked #5 Ellis belt to
 the outside punch out.
 NVO outside at the
 punch out.

Inspector's Initials

Supervisor's Initials and Date

10/15/09

Page No.

3A

Date

10/15/09

Traveled tracks back to
N Portal with [REDACTED]
& Everett Hager. NVO
while traveling the tracks.
Listed while [REDACTED] explained
root cause & analysis with
Everett.

Inspector's Initials

Supervisor's Initials and Date

Page No.

4A

Date

10/15/09

8080689

11:40

terminated 12:20

Bottom Belt roller hanger is
hot from the belt rubbing
against it. 75. 1731(b)

Locate on 4N Belt one @ 37
break + one @ 38 Break. The
belt roller hanger was smoking

The belt examiner should
have notice, because of
belt shavings under the
roller.

The violation has existed
from the beginning

Inspector's Initials

Supervisor's Initials and Date

Page No.

5A

Date

10/15/09

of the shift

4) 10 persons in by

7) Loss days or restricted
duty due to smoke
inhalation.

8) Due to dry material
under the rollers and
roller ^{structure} being hot ~~smoking~~
fire elements are present

Inspector's Initials

Supervisor's Initials and Date

Page No.

6A

Date 10/15/09 808009011/2: 38 Tu 12: 40

2) Bottom belt roll was stuck
 also was worn down
 No heat was present
 75-1731(a)

3) #5 Ellis belt, 1 break from
 the head (in by)

4) The belt ~~inspector~~ ^{examiner} should
 have known

5) The violation has existed
 for 1 shift

with 10 persons

Inspector's Initials

Supervisor's Initials and Date

10/16/09

Page No.

7ADate 10/15/09

7) ~~off 35 days~~ ^{work- restricted} ~~restricted duty~~
 because of smoke.

8) Unlikely because of
 the wet area - and
 the roller was not hot.

Inspector's Initials

Supervisor's Initials and Date

10/16/09

Page No.

7A

DAILY COVER SHEET

Date 10-14-09 Event No. 6288652Arrived at the Mine 8:00 Departed from the MineList Records Books Checked Freshshift + OnshiftLongwall, Freshshift + Onshift
TruckAccompanied By: Company Representative Jack Roles
Longwall CoordinatorMiners Representative None

AREAS OF INSPECTION ACTIVITY:

#12 Jeep, Truck from North
 Portal to the end of the
 track on the Longwall

Inspector's Initials

Supervisor's Initials and Date

10/28/09

Page No.

1

Date 10-19-09

Arrived at the MSHA office. Bump test my spotter. I got my light and SCSR. Went and got dress in the shower room. I went to my office, got my computer. Drove to USB office. I spoke to Everett Hager and Jack Roles about going to the longwall face. Checked the Preshift + Onshift for the longwall. NVO Jack #9 600, Jack #160 319. Checked the Preshift + Onshift for

Inspector's Initials

Supervisor's Initials and Date

Page No.

Date 10-19-09

the ~~track~~ track. NVO Checked the #12 Jeep. NVO. Traveled the track from the North Portal to longwall end of the track. Then I realize I needed to do a EOT. So I started a EOT from the end of the track.

Inspector's Initials

Supervisor's Initials and Date

Page No.

DAILY COVER SHEET

Date 10-20-09 Event No. 6288652Arrived at the Mine 8:00 Departed from the MineList Records Books Checked Preshift + onshift
Longwall, Exam of beltAccompanied By: Company Representative
Jack Roles, LongwallMiners Representative None

AREAS OF INSPECTION ACTIVITY:

#10 Jeep, #12 Jeep.
KVA - Starter box - 14196-1800-1
Power box hydraulic upkeep
Splitter box 28911-109
Hydraulic Long wall belt storage unit

Inspector's Initials

Supervisor's Initials and Date

Page No.

Date 10-20-09

Arrived at the MSHA office. I was going to bump test my spotter but the spotter Tyler was out of gas. I got my light and 565R. Went to my office. Checked mail. Went down stairs got shoes and loaded truck. Drove to the UBB office. spoke with Jack Rola about traveling the longwall belt. Checked the Pushift + Onshift longwall and checked

Inspector's Initials

Supervisor's Initials and Date

Page No.

Date 10-20-09

Exam of belt NVO in both book. Checked the #10 Jeep met the #12 Jeep. Rode #12 Jeep to longwall NVO. Walked from the end of the truck to the headgate NVO. Checked the intake phone it is working now. Turned 1110 am. Watch the longwall moved about 60' from jack 60 to the head back down to jack 20. Walked the longwall belt to the another drive isolation and

Inspector's Initials

Supervisor's Initials and Date

Page No.

Date 10-20-09

other notes on the other paper. I clearly communicate to the operator about my printing

Inspector's Initials

Supervisor's Initials and Date

Page No.

Date

10/20/09

Arrived MSHA office bumpert Solais

Traveled to MBB arrived
@ 8:00.Check pushift book on
longwall intake 47,890
#9 589

#160 297

MPA 7108

MPB 19,265

Check 5-10 - NVO 3-12

Ride to Longwall section
with Jack Roles &

Everett Hagan & [REDACTED] NVO

11:10 AM

Terminate the communication
system.

Longwall not running stated

Inspector's Initials [REDACTED]

Supervisor's Initials and Date [REDACTED]

Page No. 5

Date

10/20/09

running against

Headgate Stage loader
at break 86Starter box for longwall
belt. NVO

KVA @ starter box

#14196-1850-1 NVO

Starter box Blower box

Hydraulic take up unit

Storage unit NVO

Splitter box 28911-109

NVO

Traveled by out NVO

Inspector's Initials [REDACTED]

Supervisor's Initials and Date [REDACTED]

Page No. 6

Date

10/20/09

808 0093

1) 11:58 + 13:25

2) 75 1731(a)

3) Stuck bottom roller
top side worn flat at
44 break on longwall
belt. 11:58 terminated 12:02
13:25 terminate 13:45
Stuck bottom roller in
the longwall belt storage
unit. Both roller were
stuck by accumulation of stray belt.4) The belt examiner should
have known.

5) The violation has existed

Inspector's Initials [REDACTED]

Supervisor's Initials and Date [REDACTED]

Page No. 7

Date

10/20/09

long enough to wear rollers
down.

6) 1 person the belt examiner
is exposed to the Hazard

7) Smoke inhalation from hot
rollers getting the string
on fire. Loss work days.

8) Unlikely because areas
were damp.

Inspector's Initials

Supervisor's Initials and Date

10/22/09

Page No.

6

DAILY COVER SHEET

Date

10-21-09

Event No.

6288652

Arrived at the Mine

8:30

Departed from the Mine

List Records Books Checked

Pushift + Onshift

#2 Section, Pushift + Onshift #1 Section,
Pushift Exam of Belt Covers

Accompanied By: Company Representative

Everett Hager, Superintendent

Miners Representative

None

AREAS OF INSPECTION ACTIVITY:

#1 Mantle, NID #2
Section, Immediate Return
to sample NIT
found on #2 Section
#1, #2 and #3 belt
for #2 Section #1, #2
and #3 KVA for belt and
#2 splitter, Kerkli
Change Pressure Pump #2 Section
Section on Right Boller

Inspector's Initials

Supervisor's Initials and Date

10/28/09

Page No.

1

Date

10-21-09

Arrived at MSHA
office. Damp test
splitter and get light
and SCSR. Went to
my office checked
email and modified
an citation wrote
yesterday. Forwarded
the OCV up and
traveled to the
NID office. Spoke
with Everett Hager
about traveling underground.
Checked Pushift + Onshift
for the #2 Section
NID. 18480 L03. NID
Checked Pushift + Onshift
for the #1 Section

Inspector's Initials

Supervisor's Initials and Date

10/28/09

Page No.

2

Date 10-21-09

NVO LOB 29543

Traveling with

to the #2 Section

on the track.

Checked the #1

Manatee NVO.

Traveled the track to

#2 Section. NVO.

Walked to the Section

to power center checked

the power center NVO

[redacted] has the serial

number for the

power center. Made

a immediate danger

area across the

section. The roof

Inspector's Initials [redacted]

Supervisor's Initials and Date

10-28-9

Page No.

3

Date 10-21-09

Duster has visible

dust from 80 ft

from the face in

the #11 line.

[redacted] has

additional notes. Took

a air reading looking

the line curtain.

Had low air behind

the line curtain had

2200 fpm. Issued

citation. Took [redacted]

10 minutes to get the

air. The operator tighten

curtain to get air.

DTI were good across

the section. No other

violations were found.

Inspector's Initials [redacted]

Supervisor's Initials and Date

10-25-9

Page No.

4

Date 10-21-09

Took a bottle

sample in the

Dormerline return.

Traveled the #2

Section #3 belt

NVO. Checked the

KVA @ #3 Head NVO.

The #2 Head KVA

Serial # 27479-500-608

NVO

F. Kliff 05E80750 NVO

Forklift Charger

Serial # 05A13MC-2341

NVO

[redacted] walked the

#2 Section #2 Belt

NVO

Inspector's Initials [redacted]

Supervisor's Initials and Date

10-25-9

Page No.

5

Date

10-21-09
 Traveled the #2
 Section #1 Belt
 to the #5 North
 Tail. Two #1
 belt is out of align
 along the full line
 in several locations.
 The belt was realigned

Inspector's Initials

Supervisor's Initials and Date

Page No.

G20 U.S. GOVERNMENT PRINTING OFFICE: 2009-540-493

DAILY COVER SHEET

Date

10/21/09

Event No.

6288652

Arrived at the Mine

8:30

Departed from the Mine

List Records Books Checked

Preshift #2 + #1
List on 209

Accompanied By: Company Representative

Jack
Markin Section boss, Everett Hagare
Superintendent

Miners Representative

AREAS OF INSPECTION ACTIVITY:

#1 Section DTI

KVA Section power center

16266-2250-501 NVD

Pressure pump NVD

Pressure on Roofbolter B+14
Psi

#2 section 3 head KVA

27480-300-1008 NVD

#2 section #2 head - 9187-1000-496
NVD

Inspector's Initials

Supervisor's Initials and Date

Page No.

*U.S. Government Printing Office: 1997-508-470

Date

10/21/09

Arrived at MSHA office
 bump-test. Met with
 [REDACTED] on AB# and CAR.

Talked with [REDACTED] about
 USB. Got ready to go
 to USB.

Arrived at mine site at
 8:30. Check pre-shift books
 #1 section

#1 Entry - N/O 3R N/C

2 N/B

4 N/O

3 N/O #2E N/B 3R N/C

#2 section LOB 20,096

1+2 + 4-5 4 LR - N/O

3L - N/C, 3 N/B 7 scrap

LOB 18,480

Inspector's Initials

Supervisor's Initials and Date

Page No.

G20 U.S. GOVERNMENT PRINTING OFFICE: 2009-540-493

Date 10/21/09

Belts on #2 section #1 dusted

#2 N/D #3 N/D

Section #4 #1 N/D, 2 N/D, 3 N/D, 4 R N/D

5 N/D, 6 R N/D, 7 N/D.

#3 Section - Smoke search, Escape way

Ellis Switch Belts Preshift;

#3 Preshift.

Ellis out by South pumps

Intake Rooms

#1 Section Electrical Examination

AMS + CO system

Checked #1 man-trip

Travel to #2 Section

with Everett Hagar

Inspector's Initials

Supervisor's Initials and Date

Page No.

Date 10/21/09

Arrived on Section #2

KVA 16266-2250-501

Pressure pump NVO

LOB

10:05 85 fpm

 $18\frac{1}{2} \times 7 = 130$

12.20

#2 face 110 fpm

 $3 \times 6.5 = 2200$ $6 \times 16.0 = 98.4 \text{ ft}^2 \text{ - meas.}$

22.30 fpm

Inspector's Initials

Supervisor's Initials and Date

Page No.

Date 10/21/09~~Section #2~~
Spoke withabout spot bolting the
2 breaks out key.

3 Head KVA (#2 section)

27480-500-1088

Spoke with Everett
Hagar about the
violationWalked #2 Belt from #2
section NVO. @ #2 Belt

10092-1296 head-

#2 Belt off of #2 section

9189-1000-496 KVA

Inspector's Initials

Supervisor's Initials and Date

Page No.

Date 10/21/09

10462 8080094

1) 12:20 termination 12:30

2) Low air in #4 face
measure 2200 behind
line curtain. 75.370(w)(1)

3) No ^{entry} face where the
Roof bolter
panner was located
pinning top. Could see
dust around the roof bolter
from 80 feet back.

4) The roof bolter
operator & section foreman
The section foreman Jack
Martin was @ the roof bolter
just before we gone. within 5 min.

Inspector's Initials

Supervisor's Initials and Date

Page No. 12

Date 10/21/09

5) 30 minutes job off
the face area

6) 2 persons roof bolter
operators

7) Permanent disabling
due to lung disease
from dust

8) In continuing
practice reasonable likely

Correction fixed ventilation
evoked up with
255 cfm @ 12:30
5100 cfm = 51.8 cfm
near air

Inspector's Initials

Supervisor's Initials and Date

Page No. 13

Date

10/21/09 10/21/09

2) Belt not properly aligned
3) Belt rubbing rollers on off
side - can not touch to
feel hot. break 25-27
The belt was not properly
aligned.

Inspector's Initials

Supervisor's Initials and Date

Page No. 14

Date 10/21/09 808009 5
114:15 15:05

2) Belt not properly
 aligned 75.1731(b) ~~15:05~~

3) The #1 Belt off of #2
 section ~~was~~ is rubbing
 the bottom roller hanger
 from break 25 → 27
 Belt is ~~then~~ folded
 on some roller hangers
 on the off side, heat cannot
 be detected ~~from the~~

4) The belt examiners
 should have noticed +

5) The violation has existed

Inspector's Initials [REDACTED]
 Supervisor's Initials and Date [REDACTED] 10.28.9 15 Page No.

Date 10/21/09

since beginning of shift

1) Smoke inhalation causing
 loss work days

8) Unlikely - even though
 the belt is rubbing and
 some hot metal may touch
 the bottom. The area is
 well rock dust + damp.

The belt was realigned

Inspector's Initials [REDACTED]
 Supervisor's Initials and Date [REDACTED] 10.28.9 16 Page No.

Date 10/21/06

Rode out on track in
 #1 mantrip - NVO

Helped [REDACTED]
 wrote citation

Inspector's Initials [REDACTED]
 Supervisor's Initials and Date [REDACTED] 10.28.9 17 Page No.

AIR READINGS

Date 10-21-09
 Location #4 entry Roof bolter

Width 3 Bottle Sample No. _____
 Height 6.5 CH4 Detected 0.00%
 Area 20 Mean Entry 52
 Velocity 255 Time 12:30
 Quantity 5100 0220.8%
 Location #1 Immediate Return
#2 Section

Width 18 Bottle Sample No. D8536
 Height 8 CH4 Detected 0.00%
 Area 144 Mean Entry _____
 Velocity 183 Time 13:15
 Quantity 26,352 0220.8%

Inspector's Initials

Supervisor's Initials and Date

Page No.

AIR READINGS

Date 10-21-09
 Location LOB 2x3

Width 18.5 Bottle Sample No. _____
 Height 7 CH4 Detected 0.00%
 Area 130 Mean Entry _____
 Velocity 85 Time 12:00
 Quantity 11,050 20.8%
 Location #4 entry roof bolter

Width 3 Bottle Sample No. _____
 Height 6.5 CH4 Detected 0.00%
 Area 20 Mean Entry 22.35
 Velocity 110 Time 12:30
 Quantity 2200 0220.8%

Inspector's Initials

Supervisor's Initials and Date

Page No.

E01
4608436
 PRODUCTION
 DAILY COVER SHEET

Date 10-21-09 Event No. 6288652

Arrived at the Mine 7:15 Departed from the Mine _____

List Records Books Checked Pre-shift
#3 Section

Accompanied By: Company Representative
DAVID TARACZKOZY (Elec)

Miners Representative
Debbie Brown

AREAS OF INSPECTION ACTIVITY:

Secondary track to
#3 Section, 064-065
MMU,

Inspector's Initials

Supervisor's Initials and Date

Page No.

Arrive at office
Gather PPE OK and
Bump test Detector with
Known mixture.

Review UMF and sign
Appear Adequate.

Will Be Insp the 064
4608436, 04600,
Quartz 22.4 and
28.8%, 10-7-09

Quartz Analyses, will
travel to MMU to
see if there a problem
and correction, will
conduct Insp on 001

Travel to Mine Office
by COV

Meet with:
Everette Hagard
Sup.

Date 10-21-09

Inspector's Initials

Supervisor's D&I 10/26/09

Page No.

2

Inform Mr Hagard
that it was here to
see if a problem with
the #3 Section, 064-
001 MMU.

GARY MAY'S
RICK FOSTER IS the
Responsible person for
that end of mine

As Rick Major Rep is at
the mine, now Union
too miners Rep. Do what
they Right.

David TARNACZKOZY
Chief Elec.

Review map, of area
of Survey section
now go heading,
LAST Friday.

Section sample NO Rock was
taken.

Date 10-21-09

Inspector's Initials

Supervisor's D&I 10/26/09

Page No.

3

Section that those working
has a Bridge of Rock.

Problems
1-7 0% OCH 20.802
#1 SCRAP CUT
#2-5R-6-7 Need Clean
#3 None
#3-1 Danger off
#4 22' entry
#5 Part Ballast
#6 R SCRAP CUT
#7 Inby water in face
#7 R cut by need add dust

LT LOB 24.131 CFM
RT LOB 21.753 CFM

Power Center, Chargers, TRACK,
TRAVELWAY CLEAR, OIB
CHAMBER, INTAKE phone OK

Date 10-21-09

Inspector's Initials

Supervisor's D&I 10/26/09

Page No.

4

WILL Travel with:
 David TARACZKOZY
 Chief elec.
 TRAVEL by RAIL w/L
 Along Secondary Escapement
 to the #3 Section
 WALK TOWARD SECTION
 Tim Williams, Foreman
 064 Right Side
 065 Left Side
 MADE IMMEDIATE RISK
 ACROSS CARS.
 #1 20' CIM position
 0%CH 20.8
 #2 Hole thru, 0%CH
 20.802

Date 10-21-09 Inspector's Initials [REDACTED]
 Supervisor's D&I 10/26/09 [REDACTED] Page No. 4

Scoop located in the
 #2 entry 8.30
 Fairchild Scoop TWBY
 LOB without CABOR
 Canopy
 Height measured
 82"
 339-230
 S/C 62"
 W/O Canopy
 509 21
 PM 0163
 Measured LOB 77"
 2 to 3 x cut LOB
 065 IMM

Date 10-21-09 Inspector's Initials [REDACTED]
 Supervisor's D&I 10/26/09 [REDACTED] Page No. 5

BL NOT SUPPORT
 0%CH 20.802
 48" Height.
 #3 0%CH 20.8
 70'
 Average 48" Height
 #4 0%CH 20.802
 50" Average Height
 Average 55"
 D-2 ORDER 8.53
 065, Canopy NOT
 provided for the
 Scoop + ~~Canopy~~ SK
 being used

Date 10-21-09 Inspector's Initials [REDACTED]
 Supervisor's D&I 10/26/09 [REDACTED] Page No. 6

Center SIC

JOY 21

PM 0158 Ser#

#5 0%CH4 20.802
46" Average Height
IN 40'

#5R 0%CH4 20.8
IN 20'
52" Average Height

#6 Flush 0%CH4

#6R 40' IN
0%CH4 20.802

CIM Down 064
VALVE Chest, Pump

GR Average Height
51.5"

Date 10-27-09 Inspector's Initials [REDACTED]

Supervisor's D&I 10/26/09 Page No. 7

#7 Flush
0%CH4 20.802

6±0M LOB
66" Average
Height

#6 entry

Sloop Located INby
LOB NO CANOPY

064 D-2 order

NO CANOPY Provided

Section Move

FRIDAY, START
PRODUCTION 10-19-09

Date 10-21-09 Inspector's Initials [REDACTED]

Supervisor's D&I 10/26/09 Page No. 8

Sloop T337-196

Ser# Loc
6407 on the
064

RICK Foster (mine
foreman)

He was aware Best
was trying get
out the rock.

Talk to GARY MAYS
He my Boss.

9:25
JOY 21 SC
Ser# 16851A

Mr Foster stated
it would be
Thursday to have
complete provided
Ask Foreman what was the
Average Height on the right side 52"

Date 10-21-09 Inspector's Initials [REDACTED]

Supervisor's D&I 10/26/09 Page No. 9

Order Issue
Scoop #2 face
SIC 3 to 2
SIC at Dump

065

064

SC AT Dump

Scoop LOB 6 to 7

Section is Down
from the Section
Dumping point to
the face 064-065

Travel to Surface
to Inform Supervisor
by Rail Secondary
Escalway.

Date 10/21/09 Inspector's Initials [REDACTED]

Supervisor's D&I 10/26/09 [REDACTED] Page No. 10

#1
34" Coal
20" Coal
34" Rock
3" TOP
31" toward floor

86" height

Arrive on Surface

Call L. Self Inform
him of my actions

Issue 5 ORDER

Order Conference Rights
NO REMARKS

Date 10/21/09 Inspector's Initials [REDACTED]

Supervisor's D&I 10/26/09 [REDACTED] Page No. 11

Jamie Ferguson VP
was at mine, inform
him of my actions.

ASK FOR NAMES OF
MINERS ON SECTION.

Mr Ferguson stated it
would be 2 hrs to
complete putting canopy
on Equip. Call office
[REDACTED] that
to would need stay to
complete orders, no stated
use your own judgement

Inform others I will be
Doing my paper work in
GOV.

Date 10/21/09 Inspector's Initials [REDACTED]

Supervisor's D&I 10/26/09 [REDACTED] Page No. 12

Tim Williams Foreman

Miners on Section at the time Ordos Issue.

Date 10-21-09 Inspector's Initials [REDACTED]
 Supervisor's D&I 10/26/09 [REDACTED] Page No. 13
 U.S. Government Printing Office: 1997-508-470

Ord # 8086905

① 8086905

② The Fairchild scoop

③ Scoop # 339-230 being used on the 065mm #3 Section was not provided with a CAN or canopy. The entry stop was used to lay the LOR that measured an average of 60". The entry the scoop was located #2 measured 82". The Coal has a middle haul that measured 31". The Coal ribs are loose and unconsolidated material.

④ 065 #3 Section

⑤ Foreman stated he knew he had to have canopy over 42" but could not shut the section down. Tim Williams, Rick Foster said mine Foreman I would have to talk to his boss GARY MAYS

Date 10-21-09 Inspector's Initials [REDACTED]
 Supervisor's D&I 10/26/09 [REDACTED] Page No. 14
 U.S. Government Printing Office: 1997-508-470

⑥ Section was moved from a low seam to this working on 10-16-09 Began production 10-18-09

⑦ 1 op of equipment

⑧ Lost work Restricted Duty.

⑨ Reasonable likely, loose unconsolidate Coal Ribs, coming into contact of operator, Broken Bones, Bruised Body. 31" of middle haul, location of scoop measured 82", Foreman stated he observed a miner operating the scoop in the face cleaning this shift.

Broken Bones or Bruised Body parts

Date 10-21-09 Inspector's Initials [REDACTED]
 Supervisor's D&I 10/26/09 [REDACTED] Page No. 15
 U.S. Government Printing Office: 1997-508-470

Oct # 80 86 906
 ① 8:35
 ② The 504 SIC south
 PM 0163 being used on the
 065mm was NOT provided
 with a CAB OR CANOPY to
 protect operator. Average
 height of the working face
 for this SIC measured over
 6' height. The coal has a
 middle man that measured
 31" of Rock. Coal Ribs are
 loose and unconsolidated material
 #1 measured 86" #2 82"
 10B entry measured 77"
 ③ 065 #3 Section
 ④ Foreman stated he knew
 he had to have Canopies But
 could not shut the section down
 Rick Foster mine foreman stated
 I would have to talk to his
 Boss Gary Mays
 ⑤ Section moved from a
 Low Seam 10-18-09
 Began Production 10-19-09

Date 10-21-09 Inspector's Initials [REDACTED]

Supervisor's D&I 10/26/09 [REDACTED] Page No. 16

⑥ 1 Equipment operator
 ⑦ Lost Work Restricted
 Duty
 ⑧ Reasonable Likely,
 Spawning of Roof Isolated
 Area, Loose unconsolidated
 Coal Ribs 31" of middle
 Rock, The Area the SIC
 is operate measured
 60" to 82".
 Broken Bones or Bruised
 Body Parts

Date 10-21-09 Inspector's Initials [REDACTED]

Supervisor's D&I 10/26/09 [REDACTED] Page No. 17

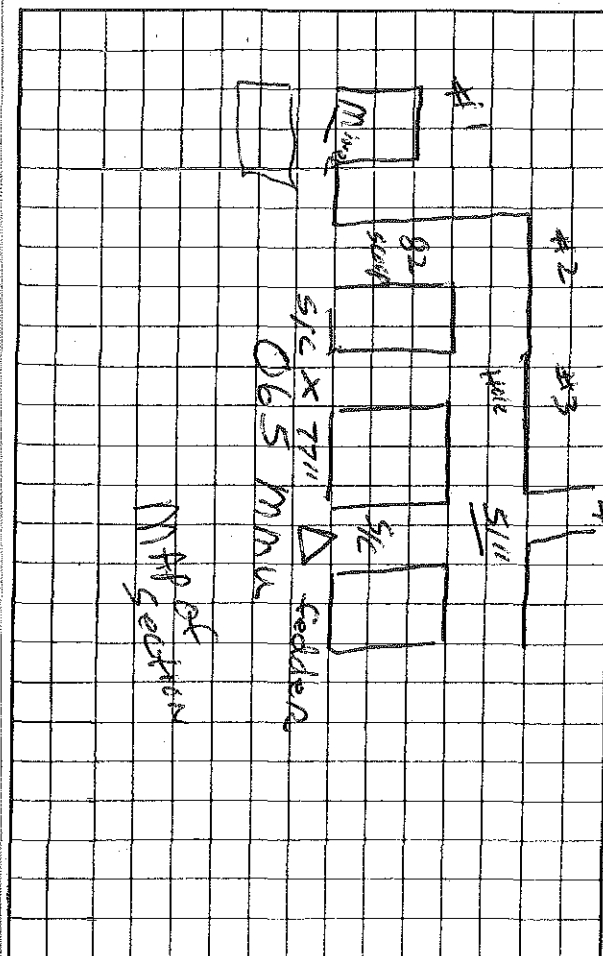

Date 10-21-09 Inspector's Initial [REDACTED]

Supervisor's D&I 10/26/09 [REDACTED] Page No. 18

C.I.# 8086907

① 8:55

② The 704 SIC SERIAL # PM 0158 being used on the 065 MMU IS NOT PROVIDED WITH A CAB OR CANOPY. The AVERAGE entry height measured where the SIC operates IS OVER 50". THIS SIC CAN GO EITHER WAY LEFT OR RIGHT AVERAGE height to the RIGHT IS 52". The Coal has a bar of Rock on the Right that measured 12". Loose unconsolidated Coal Ribs and spandling of the Roof.

③ 065 MMU #3 Section

④ Foreman Tim Williams stated he knew OVER 42" CANOPIES MUST BE PROVIDED AND HE COULD NOT SHUT THE SECTION DOWN. Rick Foster stated he knew BUT I would have to talk to his boss Gary May.

Date 10-21-09 Inspector's Initial [REDACTED]

Supervisor's D&I 10/26/09 [REDACTED] Page No. 19

*U.S. Government Printing Office: 1997 - 508-470 [REDACTED]

⑤ Section moved from a Low Seam 10-16-09
Began production 10-14-09

⑥ 1 OP of Equipment

⑦ Last WORK Restricted Duty

⑧ Reasonable Likely, NO protection provided for the Equip. operator. Roof spandling, loose unconsolidated Coal Ribs #4 entry measured AVERAGE 52" faces over 42" in all working face SIC could Be Run too BRISSED OR BROKEN Body parts.

Date 10-21-09 Inspector's Initial [REDACTED]

Supervisor's D&I 10/26/09 [REDACTED] No. 20

*U.S. Government Printing Office: 1997 - 508-47 [REDACTED]

C.I.# 8086908

① 0910

② The Fairchild scoop Ser.# 337-196 being used on the 064 MMU, #3 Section was not provided with a CAB or canopy for the protection of the operator. Entries measured with a standard Rule IS 51" Location of Scoop at 640 7 LOB measured 66 inch. Loose unconsolidated Coal Ribs spandling of Roof in isolated Areas.

③ 064 #3 Section

④ Foreman Tim Williams stated he knew ⑥ that CANOPIES were to be provided OVER 42", But could not shut the section to correct. Rick Foster stated he knew BUT I would have to talk to his boss Gary May.

Date 10-21-09 Inspector's Initial [REDACTED]

Supervisor's D&I 10/26/09 [REDACTED] Page No. 21

*U.S. Government Printing Office: 1997 - 50 [REDACTED]

③ Section moved from a Low Seam on 10/16/2009 AND began production 10-19-09.

④ 1 Equip operator

⑤ LOST WORK Restricted Duty.

⑥ Reasonable Likely, Spreading of Roof, Loose Unconsolidated Coal Ribs BRUISED OR BROKEN BODY PARTS

Case 8086909

① 9:25

② The 504 SIC Ser # 16851A being used on the 064 mm, #3 Section was not provided with a CAP OR Canopy. The entries located to the working faces measured to be 51". The location of the SIC IN BY the LCB measured 60".

③ 064, #3 Section

④ Foreman Tim Williams stated he knew he had to have Canopies But could not shut the section down. Rick Foster stated he knew But it would have to talk to his boss GARY MAYS.

⑤ Section moved from a Low Seam 10-16-09 Began production 10-17-09

⑥ 1 Equipment operator

⑦ LOST WORK Restricted Duty.

⑧ Reasonable Likely BRUISED OR BROKEN BODY PARTS, Loose Unconsolidated Coal Ribs Spawning of Roof Isolate Areas

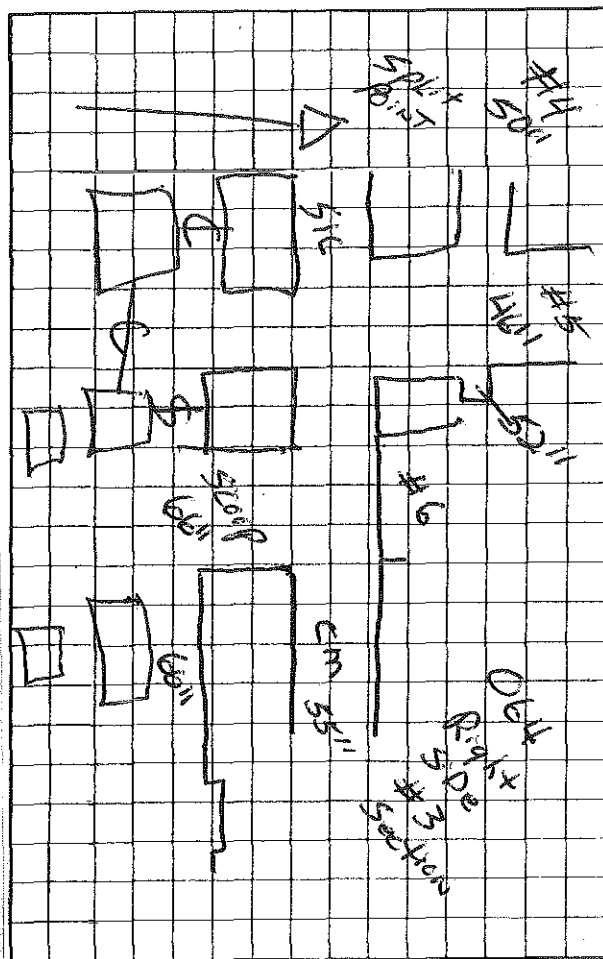
Date 10-21-09 Inspector's Initial [REDACTED]Supervisor's D&I 10/26/09 [REDACTED] Page No. 25

*U.S. Government Printing Office: 1997-508-470

[REDACTED] 10-26-9

AIR READINGS

Date 10-21-09
 Location LOB 064
6 to 7
17.25
 Width 5.5 Bottle Sample No. 00%
 Height 94.8 CH4 Detected 00%
 Area 259 Mean Entry 9.10
 Velocity 24.572 Time 20.802
 Quantity 20.802
 Location _____

Width _____ Bottle Sample No. _____
 Height _____ CH4 Detected _____
 Area _____ Mean Entry _____
 Velocity _____ Time _____
 Quantity _____

Inspector's Initials [REDACTED]Supervisor's Initials and Date 10/26/09 Page No. 26

*U.S.GPO: 1993-0-709-384

Rick Foster (Manager)
Called to GOU at 12:45
and stated the charges
are on the Equip so
it could be entered the
ORDER.

Prepare to go w/a
with M.A. Foster.

Travel w/a by RAIL
Secondary to #3 Section

WALK toward Section
from area of
track. 19X CWT

follow-up order.

Sections & I/A NO
Changes

Order 20.802

Date 10-21-09 Inspector's Initial [REDACTED]Supervisor's D&I 10/26/09 [REDACTED] Page No. 27

*U.S. Government Printing Office: 1997-508-470

[REDACTED] 10-26-9

Imm Danger Run
NVO.

TALK to Gary Mays
Concerning his Quartz
Issue. he was NOT
Aware, and will follow
up.

Travel from Section
OUT to RAIL.

Rode Man Trip from
TRACK to Surface

Term. ORDERS
GARY Mays, Sup. stated he had
down across the Section and measured
NO places under 42"

Date 10-21-09 Inspector's Initial [REDACTED]
Supervisor's D&I 10/26/09 [REDACTED] Page No. 28
*U.S. Government Printing Office 470 10209

Cit# 8086905 ✓
Fairchild scoop
SOP# 339-230
065 MMW
13:14 Canopy Provided

Cit# 8086906 ✓
JOY SIC
SOP# PM 0163
065 MMW
13:10 Canopy Provided

Cit# 8086907 ✓
JOY SIC
SOP# PM 0158
13:12 Canopy Provided

Date 10-21-09 Inspector's Initial [REDACTED]
Supervisor's D&I 10/26/09 [REDACTED] Page No. 29
*U.S. Government Printing Office 470 11262

Cit# 8086908 ✓
Fairchild scoop
SOP# 337-196
064 MMW
13:40 Canopy Provided

Cit# 8086909 ✓
JOY SIC
SOP# 16851A ✓
064 MMW
13:15 Canopy Provided

Date 10-21-09 Inspector's Initial [REDACTED]
Supervisor's D&I 10/26/09 [REDACTED] Page No. 30
*U.S. Government Printing Office 470 10209

Production ✓

DAILY COVER SHEET

Date 10-25-09 Event No. 6288652Arrived at the Mine 5:30 Departed from the Mine _____List Records Books Checked Proch. Ct + Disinfect#1 Section, Fan bookAccompanied By: Company Representative ScottSickles, DispatcherMiners Representative None

AREAS OF INSPECTION ACTIVITY:

TL North and South
Portal, North and South
Fan, Fan Books

Inspector's Initials [redacted]Supervisor's Initials and Date [redacted] 10-26-09 Page No. 1Date 10-25-09

Arrived at the MSHA
office, jump test
spotter. I pick up
my light and SCSR.
Got dress in the
locker room. Went
upstairs and got
my computer and
signed out. Loaded
my OOV and drove
to UPP office.
The twilight fan
was shut down
the alarm was
working through
the phone line.
The fan alarm for
North Fan is working

Inspector's Initials [redacted]Supervisor's Initials and Date [redacted] 10-26-09 Page No. 2Date 10-25-09

The fan alarm is
working for South
Fan. Checked the
South and North
Fan. NVD. Took
TL air samples
at North and
South Portal. NVD
checked the Fan
looked NVD.
The #4 Portal on the
North Side is the same.
The #4 Portal on the
South Side has a stopping
across it. The #5 Portal
on the South side is
the same.

Inspector's Initials [redacted]Supervisor's Initials and Date [redacted] 10-26-09 Page No. 3

AIR READINGS

Date 10-25-02
 Location #1 North Portal

Width 16 Bottle Sample No. E2111
 Height 5 CH4 Detected 0.00%
 Area 80 Mean Entry _____
 Velocity 1546-50(1446) Time 7:45
 Quantity 119,680 0.2208%
 Location #2 North Portal Truck

Width 14 Bottle Sample No. E2108
 Height 6.5 CH4 Detected 0.00%
 Area 91 Mean Entry _____
 Velocity 14515(160) Time 8:00
 Quantity 14,560 0.2208%

Inspector's Initials [redacted]Supervisor's Initials and Date [redacted] 10-26-9Page No. 4

AIR READINGS

Date 11-25-01
 Location #3 North Portal

Width 15 Bottle Sample No. E2106
 Height 5.5 CH4 Detected 0.00%
 Area 83 Mean Entry _____
 Velocity 16515(180) Time 8:10
 Quantity 14,940 0.2208%
 Location #5 North Portal

Width 16 Bottle Sample No. E2110
 Height 6.5 CH4 Detected 0.00%
 Area 104 Mean Entry _____
 Velocity 1263-35(1228) Time 8:20
 Quantity 127,712 0.2208%

Inspector's Initials [redacted]Supervisor's Initials and Date [redacted] 10-26-9Page No. 5

AIR READINGS

Date 10-25-02
 Location #1 South Portal

Width 14 Bottle Sample No. E2104
 Height 4.5 CH4 Detected 0.00%
 Area 181 Mean Entry _____
 Velocity 14615(160) Time 8:50
 Quantity 29,141 0.2208%
 Location #2 South Portal Truck

Width 14 Bottle Sample No. E2107
 Height 8.10 CH4 Detected 0.00%
 Area 190 Mean Entry _____
 Velocity 9715(108) Time 9:15
 Quantity 20,520 0.2208%

Inspector's Initials [redacted]Supervisor's Initials and Date [redacted] 10-26-9Page No. 6

AIR READINGS

Date 10-25-04
 Location #3 South Portal

Width 22 Bottle Sample No. E2112
 Height 9.5 CH4 Detected 0.00%
 Area 209 Mean Entry
 Velocity 1/4 + 13 (114) Time 9:30
 Quantity 24871 0.20840

Location _____

Width _____ Bottle Sample No. _____
 Height _____ CH4 Detected _____
 Area _____ Mean Entry _____
 Velocity _____ Time _____
 Quantity _____

Inspector's Initials _____

Supervisor's Initials and Date _____

Page No. 7

DAILY COVER SHEET

Date 10-26-04 Event No. 6288652
 Arrived at the Mine 6:30 Departed from the Mine _____
 List Records Books Checked Weekly Examination

Accompanied By: Company Representative _____

Charlie SemenskeMiners Representative None

AREAS OF INSPECTION ACTIVITY:

Weekly Exam #4 Mainrip
#4 OPP in LBB, #3 OPP
in LBB, #14 break pump LBB,
#8 break pump #28 break pump,
EP-54, EP-58, EP-53
Right Return LBB

Inspector's Initials _____

Supervisor's Initials and Date _____

Page No. 1Date 10-26-04

Arrived at MSHA
office dump. test
only spotter. Is also
get only light and
GLSR. Went to
only office get
only computer and
checked email.
Sign out in
supervisor office.
Drive to UBB mine
office. Arrived at the
mine office checked
the weekly exam
of airway. Travelled
to the ELLOR switch
NVO. Travelled the
back to #5 ELLOR head

Inspector's Initials _____

Supervisor's Initials and Date _____

Page No. 2

Date

10-26-09

#5 Ellen belt
line is black on
color, B.O.S. am,
Staring at #5 Ellen
head walking in
return for LBB.
Took air reading
at DPP #4
at spot # 21216
LBB 75x80
hole in the
return stopping.

10:00 am

Took air reading at DPP
#3. Took air reading for
Right Return LBB,
#19 LBB break Return
Pump Flyst NVO

Inspector's Initials

Supervisor's Initials and Date

10/25/09

Page No.

3

Date

10-26-09

#8 Break Flyst Pump
NVO LBB
#28 Break Flyst Pump
NVO LBB Return
Took an air reading for
Right Return Regulator. NVO
Traveled to EP-54 NVO.
Traveled to EP-58. then
traveled to EP-53. ~~EP-53~~
Took an air reading. NVO
Walked to the outside
and came out at
#5 total. NVO.
Spoke to the operator
about my findings.
I clearly communicate
to the operator about
my findings.

Inspector's Initials

Supervisor's Initials and Date

10/25/09

Page No.

4

AIR READINGS

Date

10-26-09

Location

DPP #4

Width

20

Bottle Sample No.

Height

6

CH4 Detected

0.008%

Area

120

Mean Entry

Velocity

112+15(12)

Time

9:10

Quantity

157.40

0.208%

Location

DPP #3

Width

20

Bottle Sample No.

Height

5.5

CH4 Detected

0.009%

Area

110

Mean Entry

Velocity

180+15(195)

Time

10:11

Quantity

21.450

0.208%

Inspector's Initials

Supervisor's Initials and Date

10/25/09

Page No.

5

AIR READINGS

Date 10-26
 Location Right Motor Regulator
LAB
 Width 4 Bottle Sample No. _____
 Height 6 CH4 Detected 0.00%
 Area 54 Mean Entry _____
 Velocity 776-15(10) Time 10:24
 Quantity 41.004 0.00%
 Location EP-54 in

Width 9 Bottle Sample No. _____
 Height 9 CH4 Detected 0.00%
 Area 81 Mean Entry _____
 Velocity 240(13)(245) Time 10:22
 Quantity 20,055 0.00%

Inspector's Initials [Redacted] 6
 Supervisor's Initials and Date [Redacted] 10-26-04 Page No. _____

AIR READINGS

Date 10-26-04
 Location EP-52 In
 Width 6 Bottle Sample No. _____
 Height 6 CH4 Detected 0.00%
 Area 36 Mean Entry _____
 Velocity 540-5(535) Time 11:37
 Quantity 14,260 0.00%
 Location EP-52

Width 14.5 Bottle Sample No. _____
 Height 6.1 CH4 Detected 0.00%
 Area 88 Mean Entry _____
 Velocity 660-10(650) Time 11:56
 Quantity 57,200 0.00%

Inspector's Initials [Redacted] 7
 Supervisor's Initials and Date [Redacted] 10-26-04 Page No. _____

AIR READINGS

Date 10-26-04
 Location EP-53
 Width 20 Bottle Sample No. _____
 Height 6 CH4 Detected 0.00%
 Area 120 Mean Entry _____
 Velocity 800-24(180) Time 12:13
 Quantity 93,600 0.00%
 Location _____

Width _____ Bottle Sample No. _____
 Height _____ CH4 Detected _____
 Area _____ Mean Entry _____
 Velocity _____ Time _____
 Quantity _____

Inspector's Initials [Redacted] 8
 Supervisor's Initials and Date [Redacted] 10-26-04 Page No. _____

Date

10-26-09

CITATION/ORDER #:

8080096

Time:

805 am

Location:

#5 Elbow beltline

Violation:

75.400

The #5 Elbow beltline is slack in color from the tailpiece to the belt head. The #5 Elbow beltline has great coal dust deposited on rock - dusted surface

No. of Persons Exposed:

Beltman on final pass

Inspector's Initials

Supervisor's Initials and Date

Page No.

9

Date

10-26-09

Who knew the violation existed?

[redacted] and [redacted]

How long has the violation existed?

Several shifts
3 to 5 shifts

If an accident should occur because of this type violation, how serious would it be?

Foot working from interfering spoke from a belt fire.

What is the likelihood that this type accident will occur at this mine?

Why? It is unlikely, no fire hazard was found at the time violation was found.

Inspector's Initials

Supervisor's Initials and Date

Page No.

Date

10-26-09

CITATION/ORDER #:

8080097

Time:

10:00 am

Location:

Spot # 21216 LBB Right

Violation:

Return 75.333(h)

The stopping located at spot # 21216 has an opening of 75 inches by 80 inches in the right return for LBB. All ventilation controls, including seals, shall be maintained to serve the purpose for which they were built.

No. of Persons Exposed:

weekly seminar.

Inspector's Initials

Supervisor's Initials and Date

Page No.

Date

10-26-09

Who knew the violation existed?

No body the bottom

is having causing the

How long has the violation existed?

Less than a week did not exist best work.

If an accident should occur because of this type violation, how serious would it be?

Lost working from low air in the area.

What is the likelihood that this type accident will occur at this mine?

Why? unlikely the area has alot of air improvement.

Inspector's Initials

Supervisor's Initials and Date

Page No.

PRODUCTION
DAILY COVER SHEET

Date

10-27-09

Event No.

6288652

Arrived at the Mine

8:10

Departed from the Mine

List Records Books Checked

Pre-shift

#3 Section

Accompanied By: Company Representative

Dariusz PARACZYK

Miners Representative

Dariusz

AREAS OF INSPECTION ACTIVITY:

TRACK Secondary to

#3 Section, 064-065

Dust Parameter

L+R RIB, JOY 14-10

C/M JM 5519A, 064,

Inspector's Initials

Supervisor's Initials and Date

10/28/09

Page No.

ARRIVE at office	
Gather PDE OK	
and Band test	
Detector.	
Talk to [REDACTED]	
Informing him that	
I will be at 8436	
to travel to the	
#3 Section to collect	
Respirable Dust Parameter	
on the 064-065 MMU	
this section 064	
was survey on 10-17-09	
064, 06.046	
QUARTZ 22.4 and	
28.8	
Section has been moved	
since survey was	
taken.	
Travel to mine office	
by 600.	

Date

10-27-09

Inspector's Initials

Supervisor's D&I

10/28/09

Page No.

2

Meet with GARY MAYS
Sup. ASK FOR MINERS
Rep if any to Be
CONTACT. NO MINERS Rep
CONVENTION

Review Book
Pro-shift #3 Section

#1 - Needs cleaned
#2-3 Need cleaned & Dusted
#3 1/2 BAK OIB face 6 Damage Bolts
#3R NOT Bolted
#4 Part Bolted
#5 Need cleaned & Dusted
#5R SCRAP CUT.
#6 None
#6R Damage Bolts (Damage off)
#7 Need cleaned
#7R Only water in face
#7R OIB None
LOB 22,249 CFM LT
RT 23,882 CFM
09%ch4 20.802

Date 10-27-09 Inspector's Initials [REDACTED]
Supervisor's D&I 10/28/09 [REDACTED] Page No. 3

Power Center, Charger, track
travelway clear, OIB
Chamber Intake phone
OK AT time of EXAM

[REDACTED]

OP HAS A Complete
Set of Equip, 12-12 CFM
and (3) 10 S/C waiting
for the plans to be Approved.

Inform OP that it is in there
plate to provided information
ASK by MSHA to complete
the Approval process of plans.

MR MAYS stated During MSHA
survey that the RIR crews
clean there Dust collection
Boxes out During the survey.

Date 10-27-09 Inspector's Initials [REDACTED]
Supervisor's D&I 10/28/09 [REDACTED] Page No. 4

DAVID TARACZKOZY
Chief Elec. with TRAVEL
with WRITER During Insp.

Travel from surface by
Rail along secondary
Escapeway to 19X0WT
#3 Section, EXIT MAN-trip
WALK toward Section
09%ch4 20.802
Positive pressure.

ARRIVE ON Section

MADE Imm. Danger
Run Across faces

#1 09%ch4 20.8
2.5' in.

3M" Coal
31" Rock
22" Coal

Date 10-27-09 Inspector's Initials [REDACTED]
Supervisor's D&I 10/28/09 [REDACTED] Page No. 5

#2	0% ch 4	20.802
40'		
37"	COAL	
38"	ROCK	
21"	COAL	
Tim Williams (Foreman)		
#3R	Cut through	
0% ch 4	20.8	
37"	COAL	
5"	ROCK	
#3	0% ch 4	20.802
	FLUSH	
#4	0%	20.802
43"		
	FLUSH	
4R	0% ch 4	20.802
40"		
	Cut through	

Date 10-27-09 Inspector's Initials [REDACTED]

Supervisor's D&I 10/28/09 [REDACTED] Page No. 6

#5	0% ch 4	20.802
	RIB FLUSH	
#6R	0% ch 4	20.802
41"		
In	40'	
#6	OB FLUSH	0% ch 4
	20.802	
#6R	OB	70'
62"	37" COAL	
24"		
#7	10'	0% ch 4
	20.8	
(1)	Right side	
	OB BREAK	
(2)	Left side	
LOB	OB 4 Right side	
	SS # 23023	

Date 10-27-09 Inspector's Initials [REDACTED]

Supervisor's D&I 10/28/09 [REDACTED] Page No. 7

Fletcher R13
SER# 92042-2003318
Right side - 15 Hg
Left side - 14 Hg
Left Box missing
Wing Nut #0 HOID
PRESSURE AGAINST FILTER
DUST BEHIND FILTER
9.58
Right Box
FILTER GOB
MISSING WING DUST
DUST BEHIND FILTER
DUST AT EXHAUST
PIPE
Water Box is Full

Date 10-27-09 Inspector's Initials [REDACTED]

Supervisor's D&I 10/28/09 [REDACTED] Page No. 8

CIT Issue

term 10-28-09
08:00

DTE, slowing of
Ribs, Controls in place
Oxy 4 20.8
Dust needed +
Cleaning Additional.
Root Adequately support
Fletcher RIB
Ser# 9409012008322
065 mmu.

Left side Containment
Behind filterBasket Loose, Missing
Bottom strap

Left Pot - 16 Hg.

Date 10-27-09 Inspector's Initials [REDACTED]

Supervisor's D&I 10/28/09 [REDACTED] Page No. 9

Right side

Dust Behind Filter
Containment system

- 17 Hg.

10:15 System NOT
Being maintained

No Visible Dust

Water Box System

Date 10-27-09 Inspector's Initials [REDACTED]

Supervisor's D&I 10/28/09 [REDACTED] Page No. 10

JOY 14-10 A
JM 5519 A
Ser#

064 mmu

5	4	4
14		4
4	2	4

7.5 PSI PLAN

Observed SPRAYS # 31

Pressure Observed
35 PSICIM IS Idle
Running Left side

Date 10-24-09 Inspector's Initials [REDACTED]

Supervisor's D&I 10/28/09 [REDACTED] Page No. 11

Using water gauge
at spray block
with 065 C/M
operating 55 PSI
Observed.

11:09 C/L Issue
Low water pressure

Date 10-28-09

Inspector's Initials

Supervisor's D&I 10/28/09

Page No.

12

370

C/L# 8086912

① 11:09

② The Approve Methane and
Dust plan for the 064
MMW, #3 section is not
being complied with.

Plan requires 75 PSI,
using a water gauge
at the front spray
block for the Joy 14-10A
C/M, Ser# JM 5519A

Available for use, measured
55 PSI. The 065 MMW
C/M was cutting when
exam was taken.

③ 064 MMW

④ Elec. conducted the
on shift

⑤ Prior to production
beginning of this shift

⑥ 3 (1) C/M op and

(2) S/R

⑦ permanently disabling

⑧ unlikely, spray operable
cutting 4' x 7' rock

Date 10-27-09

Inspector's Initials

Supervisor's D&I 10/28/09

Page No.

13

72:630 B

C/L# 8086910

① 9:58

② The Fletcher RIB

Ser# 92042-2003318

being used on the
064 MMW, #3 section
Dust collection system
is not being maintained
in permissible and proper
working condition. The
Dust collection system is
containment with dust
from drilling the mine
roof behind the filters
on the left & right
boxes, wings nuts
missing to the dust
filters and dust
at the end of the
exhaust pipe. Water box
is half full, no visible
dust in the mine
atmosphere during operation.

③ #3 section

064 MMW

Date 10-27-09

Inspector's Initials

Supervisor's D&I 10/28/09

Page No.

14

- (4) OP of the RIB's
 (5) EXAM Conducted By Elen stated pressure WAS CORRECT.
 (6) (2) RIB OP
 (7) Permanently Disabling
 (8) Unlikely, NO Visible DUST IN the Atmosphere.

Cite Due

10-28-09

0800

Date 10-27-09 Inspector's Initials [REDACTED]
 Supervisor's D&I 10/28/09 [REDACTED] Page No. 15

- Cite 8086911
 (1) 10:15
 (2) The Fletcher RIB Serial 940901 2008322 being used on the 065 MMW, #3 Section Dust Collection system IS NOT being maintained in proper and permissible working condition. The Dust Collection system IS CONTAMINATED FROM DUST DRILLING the Mine Rock. Accumulation of DUST IS BEHIND the filter in the L&R Box. GASKET IS NOT being maintained on the Left Door Collection Door and MISSING a STRAP on the Left Door, NO Visible AIR BORN DUST During operation.
 (3) 065 MMW #3 Section

Date 10-27-09 Inspector's Initials [REDACTED]
 Supervisor's D&I 10/28/09 [REDACTED] Page No. 16

- (4) Elen. Conducted the ON SITE, pressure CORRECT
 (5) EXAM Conducted PRIOR to Loading
 (6) (2) OP
 (7) Permanently Disabling
 (8) Unlikely, NO Visible DUST IN the Atmosphere

Date 10-27-09 Inspector's Initials [REDACTED]
 Supervisor's D&I 10/28/09 [REDACTED] Page No. 17

Pressure Pump
Bump-up and

75 PSI WAS Recorded

12:05

OBSERVED 065 RIB
Crew IN #2 Place

PPE being used
Controls IN PLACE

LOW AIR RIB

12:20

19.37 CFM

0% O₂ 20.802

Date 10-27-09

Inspector's Initials

Supervisor's D&I 10/28/09

Page No. 18

LT CIRC

75 PSI 30 SPRAYS

4

4

4

4

4

4

2

4

065 CFM

75 PSI OBSERVED

EXIT SECTION, TRAVEL
BY PATH TO SURFACE
SECONDARY ESCAPEWAY

Issue 4 C.I.E.

Offer Conference Rights
NO REMARKS

Date 10-27-09

Inspector's Initials

Supervisor's D&I 10/28/09

Page No. 19

370

LINE# 80869.3

① 12:05 12:10

② The Approve methane
AND Dust Plan for the
065 MMW IS NOT being
Complied with. The
Approve Plan Requires
3000 CFM AN 45 MEAV
were the RIB is operating
Using an Approve calibrated
ANOMETER IN the
#2 working place were
the RIB was operating
19.37 CFM AN 16 MEAV
WAS measured at the
end of the Line Curtain.

0% O₂ 20.802

③ 065 MMW #3 section
#2 working place

④ Foreman stated he
had the AIR PRIOR.

⑤ 1st Row Less than
10 MIN

⑥ (2) RIB Crew

Date 10-27-09

Inspector's Initials

Supervisor's D&I 10/28/09

Page No. 20

① Permanently Disabling
 ② Unlikely 80% ch 4 30.8
 NO visible Airborn Dust

Fly Peds were Double
 and curtain pull from
 the Coat Rib.

12:50

6264 CFM

52 MEAV

Date 10-27-09 Inspector's Initials [Redacted]
 Supervisor's D&I 10/28/09 [Redacted] Page No. 21

Complete today Insp
 Arrive to office. Return
 Gear and PPE
 Prepare today's Action

Date 10-27-09 Inspector's Initial [Redacted]
 Supervisor's D&I 10/28/09 [Redacted] Page No. 22

AIR READINGS

Date 10-27-09
 Location LOB 1 to 2
065

Width 19 Bottle Sample No. _____
 Height 7.5 CH4 Detected 0%
 Area 142.5 Mean Entry _____
 Velocity 159 Time 9:20
 Quantity 22.65M 20.802

Location LOB 6 to 7 064
1M

Width 1M Bottle Sample No. _____
 Height 4.5 CH4 Detected 0%
 Area 76.5 Mean Entry _____
 Velocity 280 Time 9:40
 Quantity 21.430 20.802

Inspector's Initials [Redacted]
 Supervisor's Initials and Date [Redacted] 10/28/09 Page No. 23

AIR READINGS

Date 10-27-09
 Location #2 RIB A
124

Width 7 Bottle Sample No. _____
 Height 7.15 CH4 Detected 0%
 Area 15.5 Mean Entry 16
 Velocity 1937 Time 12:20
 Quantity 20.8
 Location 120

#2 RB
 Width 83 Bottle Sample No. _____
 Height 8 CH4 Detected 0%
 Area 24 Mean Entry 52
 Velocity 24615 261 Time 12:50
 Quantity 6264
20.802

Inspector's Initials [redacted]Supervisor's Initials and Date [redacted]Page No. 214

DAILY COVER SHEET

Date 10-28-09 Event No. 6288652

Arrived at the Mine 5:30 Departed from the Mine _____

List Records Books Checked Weekly Exam
of Airway

Accompanied By: Company Representative
Charlie Semensky, Fire Boss

Miners Representative None

AREAS OF INSPECTION ACTIVITY:

#8; back ramp, Intake for
Old North Mains, DPP#2
ramp in face Old North Mains,
Intake to #1 Section, #1 Section
Exes, DTL, N100,

Inspector's Initials [redacted]Supervisor's Initials and Date [redacted]Page No. 1

Date 10-28-09

Arrived at the MSHA
office. Dump load spotted
and got my light and
SCSR. Went my
office got my computer
and sign out. Went
down to the locker
room and got dress.
Drove to the UBB
mine office. I got
dress in the parking
lot. Went upstairs
and spoke with
Everett Hagan and
[redacted] about
not having a
approved ventilation
plan to mine in

Inspector's Initials [redacted]Supervisor's Initials and Date [redacted]Page No. 2

Date 10-28-09

the #2 Section, They
 began mining on 10-8-09
 on the #2 Section.
 I issued an order
 at 5:35 a.m.
 I checked the weekly
 exams on my way into
 Ellis switch. While
 traveling the track
 just into Ellis
 switch the airlock
 doors were open.
 I issued violation at
 6:10 a.m. Rode the
 ore cart to
 the #7B break.

Inspector's Initials

Supervisor's Initials and Date

Page No.

3

Date 10-28-09

checked #85 work
 Pump Flygt J075050-
 06300
 Walked the Jorntake
 for Old North Main.
 Took air reading
 for OPP #2
 Area = 160 x 164 = 15(179)
 28,640 CFM
 0.20 B% CH₄ 0.30 %
 Pump in the Old North
 Main
 7125.051-040000
 Intake for North Main
 to #1 Section.
 Checked the intake phone
 for the #1 Section NVD
 Travel across the face

Inspector's Initials

Supervisor's Initials and Date

Page No.

4

Date 10-28-09

#1-4 faces NVD. NVD
 on the #1 Section.
 OTI were sent
 across the section.
 Walked the track
 to the to the
 Longwall and
 #1 Section switch.
 NVD. I traveled
 on the track from
 Longwall + 1 Section
 switch to the surface
 NVD. I spoke to
 Everett Vager about
 my findings I
 clearly announced
 to him about my
 findings.

Inspector's Initials

Supervisor's Initials and Date

Page No.

5

Date

10-28-09

CITATION/ORDER #:

808099

Time:

626 am

Location:

Airtank Doors Ellis switch

Violation:

75.333(d) (3)

The airtank located on the truck entry to the Ellis switch is open on both sides. When an airtank is used, one side of the airtank shall remain closed. When not in use, both sides shall be closed.

No. of Persons Exposed:

10, the

number of people on the main trip. This is wrong

Inspector's Initials

Supervisor's Initials and Date

1159

Page No.

6

Date

10-28-09

Who knew the violation existed?

The last person or persons that went through the airtank door.

How long has the violation existed?

Several minutes.

If an accident should occur because of this type violation, how serious would it be?

Lost workday. The air is going to be less in other parts of the mine

What is the likelihood that this type accident will occur at this mine?

Why? Unlikely.

The mine has alot of air.

Inspector's Initials

Supervisor's Initials and Date

1159

Page No.

7

DAILY COVER SHEET

Date

10-28-09

Event No.

6288652

Arrived at the Mine

8:09

Departed from the Mine

List Records Books Checked

Pre-shift

#3 Section

Accompanied By: Company Representative

GARY MAY (Supt.)

Miners Representative

None Present

Deadline

AREAS OF INSPECTION ACTIVITY:

TRACK Secondary to 19X1WT
#3 section, follow-up cites
Immdanger Run across
064-065 Faces,

Inspector's Initials

Supervisor's Initials and Date

11-3-9

10/28/09

Page No.

1

Arrive at office
 Gather PPE Check
 Pump test Doctor.
 Look ahead to
 4608436 to follow
 up on costs due
 today. Travel
 by GOV to mine
 office.
 Meet with
 GARY MAYS (sup.)
 Ask if IS are were
 clear on the #3
 Section RIB
 Condition corrected
 RIB system is clean
 + maintained
 Ask Miner Rep if any to
 Be CONTACT None Present

Date 10-28-09 Inspector's Initials [redacted]
 Supervisor's D&I 10/30/09 [redacted] Page No. 2
 U.S. Government 11-3-9 1997 - 508-470

Pre-shift #3 Section
 064-065 mmu
 #1-2 Need Cleaned
 #3-4 Need Cleaned
 #5 Need Dusted
 #6 Need Clean + Dusted
 #6R Inby SCRAP OUT
 #6R OIB Damage Bolt (Dagosa)
 #7 Need Cleaned
 #7R Inby Water intake
 #7R OIB None observed
 LOB
 23,403 CFM L
 21,097 CFM R
 Power centers, charges, track,
 travel way, OIB chambers
 intake phone, OK at time of
 Exam
 070ch4 20.802
 [redacted]

Date 10-28-09 Inspector's Initials [redacted]
 Supervisor's D&I 10/30/09 [redacted] Page No. 3
 U.S. Government 11-3-9 1997 - 508-470

Travel LG with GARY
 MAYS from Surface by
 Rail ride to 19K cut #3
 Section, Secondary Escapeway
 070ch4 20.802
 Walk to Section:
 Made Imm. Danger Run
 Across Faces.
 DAVID TARACZKOZY
 (Chief Elec.) Accompany
 During Insp.
 #1 070ch4 20.802
 60' IN
 #2 070ch4 20.802
 60' IN
 #3 070ch4 20.802
 C/M Loading
 IN 101
 #3 Face Flush

Date 10-28-09 Inspector's Initials [redacted]
 Supervisor's D&I 10/30/09 [redacted] Page No. 4
 U.S. Government 11-3-9 1997 - 508-470

Cit # 8086910
RIB Ser # 92040-203318
064 mm, Dust Collection
System

-15 Right

-12 Left
New filter provided
wing NATS

9:50

Cit # 8086911
RIB Ser # 94091208322
065 mm, Dust Collection
System

-20 Left

-18 Right

System cleaned
being maintained

9:15

Date 10-28-09 Inspector's Initials [redacted]

Supervisor's D&I 10/30/09 [redacted] Page No. 5

U.S. Government Printing Office: 1997-508-470

#4 00%ch4 20.802
IN by 6'

9:30 face NOT supported
WITHIN 4' PRIOR to
Equipment being
OP by the #4 face
Measured 6' to to
Coal face from
up supported
DANGER Bolt
Spear off on the
Right O/S of #4
Face Measured

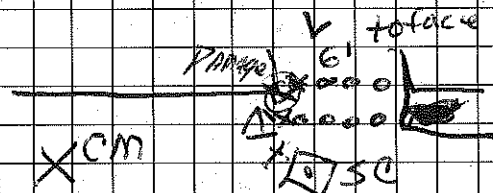

SS# 24106 #2 entry
LOB

Date 10-28-09 Inspector's Initials [redacted]

Supervisor's D&I 10/30/09 [redacted] Page No. 6

U.S. Government Printing Office: 1997-508-470

#5 00%ch4 20.8
Stamp

#6R NOT Bolted
00% 20.802
IN 25'

#6R OB
401 00%ch4 20.802

#7 IN 10'
00%ch4 20.802

DTI Sloughing
of Ribs
00%ch4 20.802

11 OPEN BRK Right
(2) ON Left

Additional Cleaning Road
Roof Adequately supported
OPYS cleaning
Roof being done

Date 10-28-09 Inspector's Initials [redacted]

Supervisor's D&I 10/30/09 [redacted] Page No. 7

U.S. Government Printing Office: 1997-508-470

① # 8086914
 ② 9:30
 ③ The Approve Roof Control Plan at this mine is NOT being complied with on the 064MMU #3 section in the #4 working face. The permanent support measured with a standard rule to be 6' from the coal face, A shuttle CAR is being operated by the affected Area to the C/M located IN 3L X-CUT, C0B In the face providing Area to be supported OR observed.
 ④ #3 section 064MMU
 ⑤ EXAM should have noticed
 ⑥ appear from last shift production very slow
 SIC has pulled 10' from C/M IN 3L

Date 10-28-09 Inspector's Initials [REDACTED]
 Supervisor's D&I 10/30/09 Page No. 8
 U.S. Government Printing Office 1039 1-39 197-508-470

⑩ 1 SIC OP
 ⑪ Lost Work Restricted Daily
 ⑫ UNLIKELY, NO UNCONSOLIDATED MATERIAL, SIC provided with canopy
 Area Clean & supported to within 4' of the coal face
11:30

Date 10-28-09 Inspector's Initials [REDACTED]
 Supervisor's D&I 10/30/09 Page No. 9
 U.S. Government Printing Office 1139 1-39 197-508-470

Depart from Section
 Travel toward track
 Ride Rail trip to surface
 Secondary escape route
 Arrive on surface
 Team 2
 Issue & Term 1
 Offer Conference Rights
 NO Remarks

Date 10-28-09 Inspector's Initials [REDACTED]
 Supervisor's D&I 10/30/09 Page No. 10
 U.S. Government Printing Office 1139 1-39 197-508-470

E01
4608436

MSHA Form 7000-101, June 93 (revised)

DAILY COVER SHEET

Date 11-2-09 Event No. 6288652

Arrived at the Mine _____ Departed from the Mine _____

List Records Books Checked _____

Accompanied By: Company Representative _____

Miners Representative _____

AREAS OF INSPECTION ACTIVITY:

Modified CIT
8086914

Inspector's Initials _____

Supervisor's Initials and Date 11/02/09 Page No. 1

*U.S. Government Printing Office: 1997 - 508-470

MSHA Form 7000-101, June 93 (revised)

DAILY COVER SHEET

Date 11-2-09 Event No. 6288652

Arrived at the Mine 6:30 Departed from the Mine _____

List Records Books Checked Production

Accompanied By: Company Representative _____

Everett Hager, Super

Miners Representative None

AREAS OF INSPECTION ACTIVITY:

Truck, #5 Elgin
#12 Jeep, Old #3 Head
KVA VBB

Inspector's Initials _____

Supervisor's Initials and Date 11/3/09 Page No. 1

*U.S. Government Printing Office: 1997 - 508-470

MSHA Form 7000-10K, June 93 (revised)

Date 11-2-09

Arrived at the
MSHA office, drove
that CIT spotter
and got right out
6:52. I got stuck
in the locker room.
Went to my office
got my computer
and sign out.
Drove to the
UBB mine office.
Spoke with Everett
Hager about #2
Section ventilation
plans. Checked the
bell book. Checked
the #12 Jeep, rode
to old #3 Bell head

Inspector's Initials _____

Supervisor's Initials and Date 11/3/09 Page No. 2

GPO: U.S. GOVERNMENT PRINTING OFFICE: 2009 - 540-493

Date

11-2-04

Checked the XVH
 @ old #7 LBD Heat
 Serial # 10083-500-1276
 NVO. Walked to
 the lounge stopping
 @ 71216 it has
 been repaired.
 Traveled the #5
 Ellis Wellline
 in two hours
 rock dusted from
 the tail to the
 head NVO while on
 the track to Ellis
 punchout. Traveled
 the track back to
 the surface at the
 North Portal. NVO

Inspector's Initials

Supervisor's Initials and Date

Page No.

GPO: U.S. GOVERNMENT PRINTING OFFICE: 2009-540-493

Date

11-2-04

Had a meeting
 with 5 men about
 winter alert. Management
 had meetings with
 the men about opening
 and closing of sub
 ways.

Inspector's Initials

Supervisor's Initials and Date

Page No.

GPO: U.S. GOVERNMENT PRINTING OFFICE: 2009-540-493

Production

DAILY COVER SHEET

Date

11-3-04

Event No.

6288652

Arrived at the Mine

5:30

Departed from the Mine

List Records Books Checked

Weekly Examination

of survey

Accompanied By: Company Representative

Charlie Semanaka Weekly
 Examiner Andy Carlson, Mine
 Miners Representative

AREAS OF INSPECTION ACTIVITY:

Safety Talk Winter Alert,
 #1 Mountain, #36 Break through
 #5 Break to #35 Break North Mining
 #2 Section #79 Break to #31 Break
 #79 Return Regulator to Brandywine Fan,
 #2 Entry from Brandywine Fan to
 #79 Break.

Inspector's Initials

Supervisor's Initials and Date

Page No.

*U.S. Government Printing Office: 1997-508-470

Date 11-3-04

Arrived at MSHA
office, bump tail speller
and get my SLR and
light. Left desk in
the locker room and
went upstairs and
got computer and sign
out. Arrived at the
UBB mine office to get
my stuff ready to
go underground. Went
up stairs to check
packs - one pack goes
Will be traveling from
5 break North Main to
6 break North Main.
Traveling #2 Section
intake from 75 break to

Inspector's Initials

Supervisor's Initials and Date

Page No.

GPO: U.S. GOVERNMENT PRINTING OFFICE: 2009-540-493

Date 11-3-04

31 break. Traveling
return from regulation
on #2 Section to
Brandytown fan #1
Entry. Traveling return
from Brandytown down
#2 Entry to #78 break.
~~Traveling~~ Traveling
Primary escapement
from #81 break to
#5 break North Main
Winter Alert
Ventilation, Rock dusting
Examinations, escaping
11 Ingress crew #1 and #2 Section.
Outing crew. Traveled
to #5 break North Main
#4 North Bellin

Inspector's Initials

Supervisor's Initials and Date

Page No.

GPO: U.S. GOVERNMENT PRINTING OFFICE: 2009-540-493

Date 11-3-04

in the #1 Main
NVD while on
the truck. The
#1 Main has the
NVD on it.
Start walking at
#5 break in the
intake. Checked #36
break pump Flygt
NVD, #74 break
Flygt Pump serial #
0350005 NVD
Air Reading at #84 break
in the intake.
Walked to the double
door at #81 break. NVD
while in the intake.
Walked down to #78

Inspector's Initials

Supervisor's Initials and Date

Page No.

GPO: U.S. GOVERNMENT PRINTING OFFICE: 2009-540-493

Date

11-3-09

break switch. Batteries are
 also intact for #7 section.
 Traveled from the #78
 break in the intake
 to #31 break to #2
 section. NVD took
 air reading. Main return
 for the Longwell
 and #2 section.
 Took air reading on
 all 3 sides of
 the Bardighon from
 0° 20.8%, highest
 CH4 0.40%, NVD
 In the #2 Entry @ Spab #
 23349 the stopping between
 the #2 and #3 entry
 has a 55 inches wide

Inspector's Initials

Supervisor's Initials and Date

11-5-9

Page No.

5

Date

11-3-09

by 30 inches high
 11:30 am.
 Took air reading
 EP2 for the Longwell
 Area 54 V760-15(745)
 R = 40.230
 0° 20.8%, CH4 0.10%
 Traveled down the
 #78 break NVD,
 Traveled to the
 from #78 back to
 the North portal NVD
 spoke with [redacted]
 [redacted] not clear
 of isolation. Clearly
 communicate to him
 about any findings

Inspector's Initials

Supervisor's Initials and Date

11-5-9

Page No.

6

AIR READINGS

Date

11-3-09

Location

#34 break intake

Width

14.5

Bottle Sample No.

Height

7.25

CH4 Detected

0.00%

Area

145

Mean Entry

Velocity

220.15(235)

Time

7.53

Quantity

33.370

0.00%

Location

Return Regulator
for #2 section

Width

2.5

Bottle Sample No.

Height

4

CH4 Detected

0.00%

Area

10

Mean Entry

Velocity

2064-65

Time

8.40

Quantity

19.999

0.00%

Inspector's Initials

Supervisor's Initials and Date

11-5-9

Page No.

7

AIR READINGS

Date 11-3-09
 Location Bandytown Fan
#1 Entry

Width	<u>20</u>	Bottle Sample No.	<u>01405</u>
Height	<u>6.5</u>	CH4 Detected	<u>0.05%</u>
Area	<u>130</u>	Mean Entry	
Velocity	<u>780</u>	Time	<u>10:50</u>
Quantity	<u>101,400</u>		<u>0.220.8%</u>

Location Bandytown Fan
#2 Entry

Width	<u>20</u>	Bottle Sample No.	<u>08541</u>
Height	<u>6</u>	CH4 Detected	<u>0.08%</u>
Area	<u>120</u>	Mean Entry	
Velocity	<u>1768.5 (177)</u>	Time	<u>10:56</u>
Quantity	<u>205,360</u>		<u>0.220.8%</u>

Inspector's Initials

Supervisor's Initials and Date

*U.S.GPO:1993-0-709-384

AIR READINGS

Date 11-3-09
 Location Main Return Cor
Longwall and #2 Section

Width		Bottle Sample No.	
Height		CH4 Detected	<u>0.00%</u>
Area	<u>126</u>	Mean Entry	
Velocity	<u>464</u>	Time	<u>10:03</u>
Quantity	<u>58464</u>		<u>0.220.8%</u>

Location Fan Bandytown inby side
#1 Section Return

Width	<u>20</u>	Bottle Sample No.	<u>08520</u>
Height	<u>6</u>	CH4 Detected	<u>0.30%</u>
Area	<u>120</u>	Mean Entry	
Velocity	<u>1212 (117)</u>	Time	<u>10:44</u>
Quantity	<u>141240</u>		<u>0.220.8%</u>

Inspector's Initials

Supervisor's Initials and Date

*U.S.GPO:1993-0-709-384

Date 11-3-09
 CITATION/ORDER #: 8080100
 Time: 11:30 AM
 Location: SMA# 23344 #2 Entry
 Violation: 75.333(h)
The stopping limit of
speed #23344 between
#2 and #3 entry has an
opening measured 53
inches wide by 30
inches high in the
middle end of the
stopping

No. of Persons Exposed: Only fivehours on weekly basis

Inspector's Initials

Supervisor's Initials and Date

GPO: U.S. GOVERNMENT PRINTING OFFICE: 2009-540-493

Date

11-3-09

Who knew the violation existed?

The boss might have

known from the previous week inspection

How long has the violation existed?

Less than 7 days

If an accident should occur because of this type violation, how serious would it be?

No lost Workday

What is the likelihood that this type accident will occur at this mine?

Why? unlikely, the area is all going toward the 2nd floor

Inspector's Initials

Supervisor's Initials and Date

Page No. 11

DAILY COVER SHEET

Date

11-4-09

Event No.

6588672

Arrived at the Mine

9:00

Departed from the Mine

List Records Books Checked

Machinery & other

#2 Section

Accompanied By: Company Representative

Everett Hager, Super

Miners Representative

None

AREAS OF INSPECTION ACTIVITY:

Scrubber bearings on the
Left & Right Miners on
#2 Section

Inspector's Initials

Supervisor's Initials and Date

Page No. 1

Date

11-4-09

Arrived at the
MSHA office. Pump
took spotter and
got my light at
SSSB.Went to locker room
got dress, I went
upstairs to get my
computer. I spoke
with [REDACTED]
about a citation I
issued on 2nd
Section, meaning
with a respirator.Drove to UCB
mine office. Spoke

Inspector's Initials

Supervisor's Initials and Date

Page No. 2

Date

11-4-09

Everett about
checking scrubber
reading. The
operator said that
he was not taking
a deep cut.

I checked the scrubber
and left look for
violations. NVO

Traveled to the
2 section. Now
known as # 23
Headgate.

NVO while on
the truck to the

Inspector's Initials

Supervisor's Initials and Date

11-4-09 Page No. 3

Date

11-4-09

section.

Walked to the # 2
section from the truck
NVO

Walked across the
section NVO while
going across the section

Date, Time and Initials
were good across the
section

The section was well
rock dusted.

Inspector's Initials

Supervisor's Initials and Date

11-5-09 Page No. 4

Date

11-4-09

Went to the high
miner and checked
the scrubber
reading. 6,072 CFM
of air.

Talk to the roof
bolter operator
about winter ahead.

Then I traveled to
left miner to
check the scrubber.
6,493 CFM

I watch the bolter
in # 7 string.
NVO

Inspector's Initials

Supervisor's Initials and Date

11-5-09 Page No. 5

Date

11-4-09

I traveled with
Everett to the
end of the truck
NVO

We rode the
truck to the
North Portal.
NVO

Inspector's Initials

Supervisor's Initials and Date

Page No.

GPO U.S. GOVERNMENT PRINTING OFFICE: 2009-540-493

MSHA Form 7000-10I, June 93 (revised)

DAILY COVER SHEET

Date

11-4-09

Event No.

5288652

Arrived at the Mine

5:00

Departed from the Mine

List Records Books Checked

Reshift 10 shift

Headgate #23 040

Accompanied By: Company Representative

Andy (Coal) Mine Foreman

Miners Representative

NVO

AREAS OF INSPECTION ACTIVITY:

Respirable dust, Escapement
map, Communication, First
aid equipment, Supplemental
roof supplies, Mantrip
observation, Portable
water, toilet, fire fighting
equipment, NVO, OIT
#8 Mantrip, #4 Mantrip

Inspector's Initials

Supervisor's Initials and Date

Page No.

*U.S. Government Printing Office: 1997-508-470

Date

11-4-09

Arrived at the
MSHA office. I hung
out my CH4 meter.
I also got my light
and 5CSK. Went
up stairs got my
computer and to sign
out. Went to locker
room got dress.
I test voltage on
the dust pumps
under load. I packed
up the Jeep and
drove to the UBB
office. I pass out
a pack of winter
alot stickers. I
spoke with Everett

Inspector's Initials

Supervisor's Initials and Date

Page No.

GPO U.S. GOVERNMENT PRINTING OFFICE: 2009-540-493

Date 11-9-04

about running dust
on 040-0. I
checked the brush
+ Oashift back.
Spoke with the Headgate
#23 Section (040-0),
about the respirable dust
plan. I went on
the #4 Mantrip.
Checked the #4 Mantrip
NVO. Rode the #4
Mantrip to the
Headgate #23 Section
NVO while on the
track. Arrived at
the Headgate #23
Section. Tony Moore
spoke to the men

Inspector's Initials

Supervisor's Initials and Date

Page No.

3

Date 11-9-04

about roof controls
and respirable
dust plan.

I went and hung
dust pump in the
intake the ~~life~~
life line is up
and the place is
working.

First aid box
NVO

Escapeway Map NVO
Supplemental roof supplies
NVO

Portable potty
NVO

Inspector's Initials

Supervisor's Initials and Date

Page No.

4

Date 11-9-04

Portable Water
NVO

Portable Phone NVO
Fire fighting equipment
NVO

Outlet shelter in
the intake NVO
NFRD, DIF focus good.
Watch the miner
in the #4 Entry
mined 20ft.
NVO

Watch the miner
cut in #3 Left face
just started cutting
20ft.

Inspector's Initials

Supervisor's Initials and Date

Page No.

5

Date 11-9-09

Watch the Miner
in the #7 shaft
mined 20ft
in the #7

20 inches Rock
45 coal

Watch the miner
in #2 shaft
20ft

#4 shaft
rock.

Mined total 100ft.

8 raw ton per foot
9 hrs 140 feet

8 hrs 124 feet

AVG 8 hrs 992 tons, today 800 tons

Inspector's Initials [redacted]Supervisor's Initials and Date [redacted] 11-6-9Page No. 6Date 11-9-09

Rode #8 Mantrip
to the North
Portal NVO
while on the
track,

#8 Mantrip
NVO

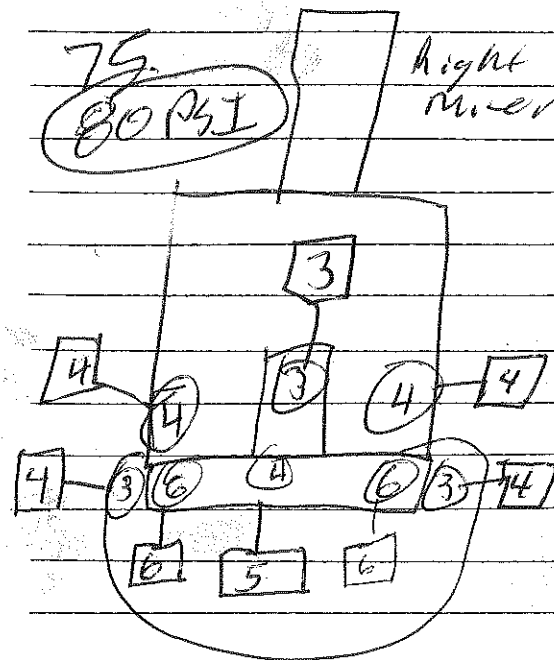
Inspector's Initials [redacted]Supervisor's Initials and Date [redacted] 11-6-9Page No. 7Date 11-9-09Inspector's Initials [redacted]Supervisor's Initials and Date [redacted] 11-6-9Page No. 8